

# UP **2** DATE

## ACCURATE CUTTING EDGE COOLING

DirectCooling (DC) system  
by CERATIZIT –  
now for turning holders!

### ... AND SOME MORE PRODUCTS

- ▲ Stationary 3-jaw chuck SBF-3 for Clamping round components
- ▲ Inserts with wear detection for turning ISO-P steels

TEAM CUTTING TOOLS



CERATIZIT is a high-technology engineering group specialised in cutting tools and hard material solutions.

**Tooling the Future**

[www.ceratizit.com](http://www.ceratizit.com)

# Welcome!



It couldn't be easier

## Ordering via the Online Shop

<http://cuttingtools.ceratizit.com>



On-site technical support

## Your Local Technical Sales Engineer

Your customer number

# Tool holders with DirectCooling (DC)

Targeted coolant application on the cutting edge



## Targeted action is half the battle

Machining without cutting fluids? It's hard to imagine in many cases because they are so efficient at cooling, lubricating and evacuating chips. But CERATIZIT has an even better alternative in the form of its DirectCooling system: two nozzles in the holder apply the coolant directly to the cutting edge – for cool machining results! Whereas a hose would typically direct liberal amounts of coolant towards the machining area, the DirectCooling (DC) system from CERATIZIT takes a different approach. Tool holders with DirectCooling (DC) are equipped with two inner holes that guide the coolant to where it has the greatest impact: directly on the cutting edge. Why is this so important? Targeted cooling improves both the service life and general process security.

- ▲ Fewer trapped chips
- ▲ Reduced wear
- ▲ Universal application

## Advantage/benefit

The lengths of all CERATIZIT DirectCooling holders are ideally matched to one another. As a result...

- ▲ Interference contours are eliminated
- ▲ A compact complete package is created
- ▲ Optimum stability is reached
- ▲ Unlimited flexibility is achieved

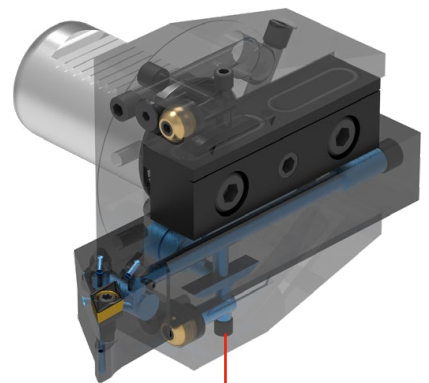

VDI square adapters – DC

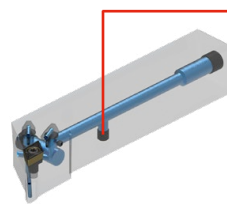

Rotating holder:  
MaxiLock – S-DC

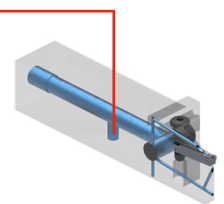

Grooving tool holder:  
MonoClamp – GX-DC



# MaxiLock – S-DC rotating holder with DirectCooling

Three nozzles for the  
ultimate cooling effect

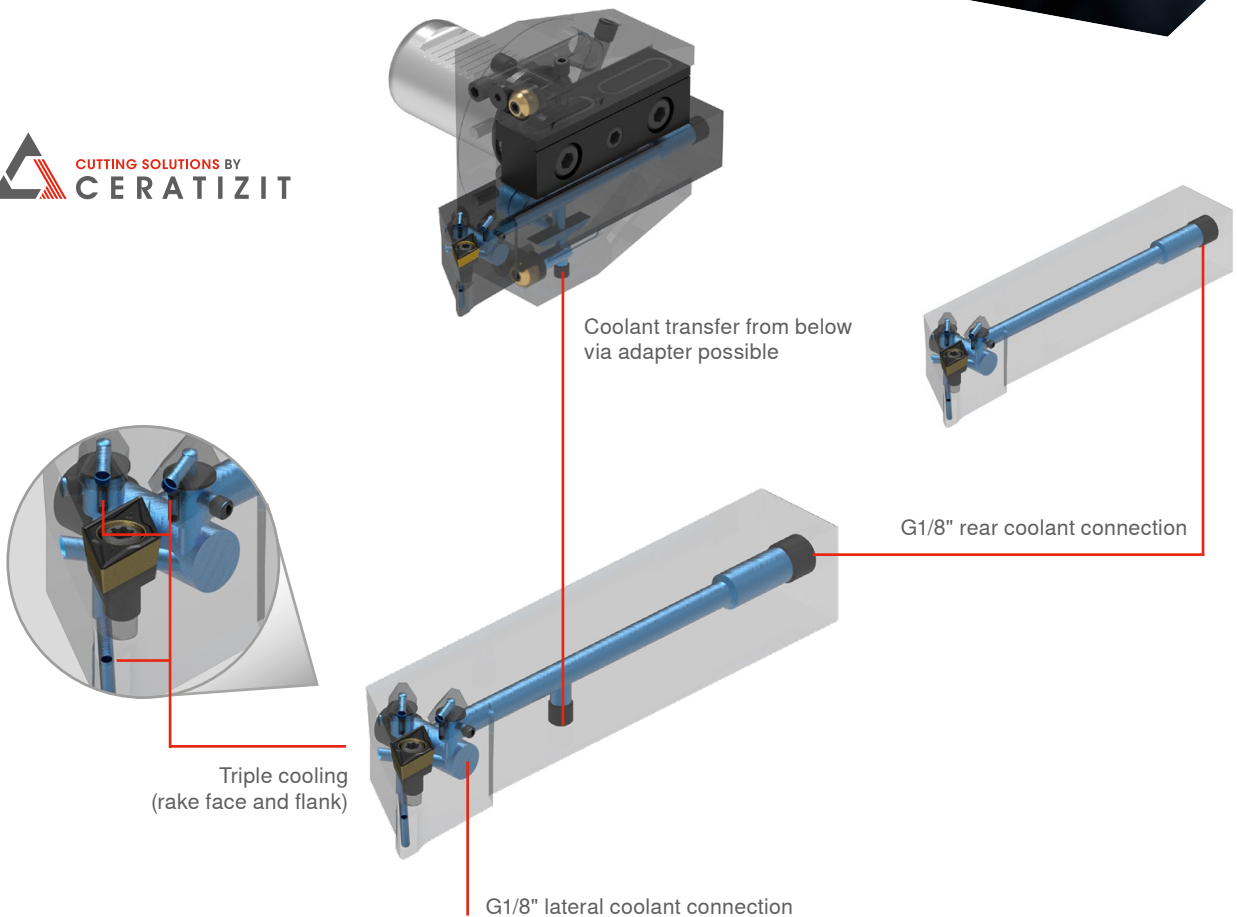

- ▲ Fewer trapped chips
- ▲ Reduced wear
- ▲ Universal application



[cuttingtools.ceratzit.com/ie/en/direct-cooling](http://cuttingtools.ceratzit.com/ie/en/direct-cooling)

## Features

- ▲ The new MaxiLock – S-DC tool holders improve both your process security and the service life of the tool cutting edges with targeted cooling.
- ▲ The revamped insert seat ensures increased stability when clamping the indexable insert.
- ▲ In combination with our flexible VDI adapters, the coolant transfer of the machine occurs unseen, without the hassle of a connection.

## Test Report

### Material:

1.4301 – X5CrNi18-10

### Cutting data:

f 0.25 mm/rev  
a<sub>p</sub> 2.00 mm  
v<sub>c</sub> 200 m/min

### Insert:

CCMT 120408EN-M55 CTPM125

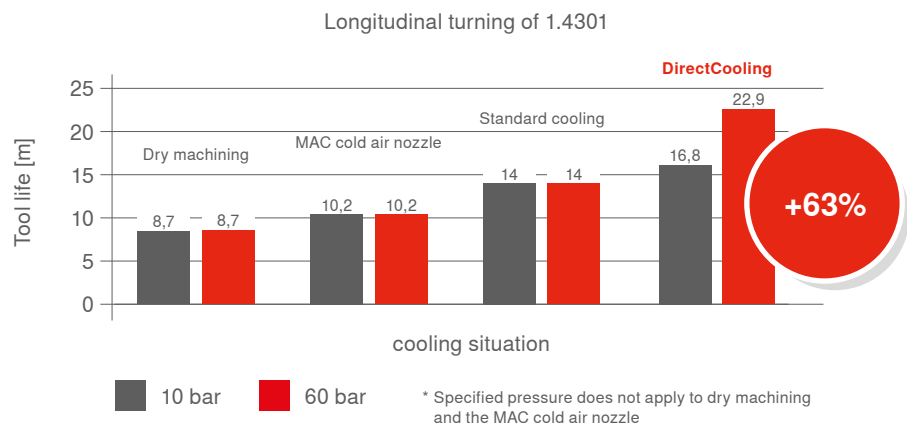

**Result:** With the DirectCooling cooling system, the tool life can be increased by **63 %** compared to a conventional cooling situation.

What's interesting here is that the lower coolant hole on the flank of the indexable insert has a considerable influence on the tool life. While cooling exclusively through the upper two nozzles gives rise to an improvement of just 22 %, flank cooling achieves an increase of 54 % compared to standard cooling!



Further information can be found on → Pages 40–55

# Steel machining made easy

The new ISO-P grades with indicator layer  
for high-performance turning processes!



## Machining with no compromises – with the CERATIZIT ISO-P carbide grades update

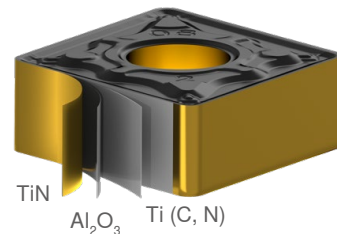

Thanks to a CVD multilayer coating with the latest Dragonskin coating technology, the indexable inserts are ideally suited to versatile steel machining. In combination with a balanced carbide base substrate, the new grades in the ISO-P category boast a wide application area with improved wear resistance.

Depending on the cutting conditions, the perfect cutting material can be selected from three grades:

**NEW**



**CTCP115-P**

- ▲ ISO-P15
- ▲ Wear-resistant grade with high degree of elevated-temperature resistance for steel machining with optimum tool life
- ▲ High cutting speeds
- ▲ Maximum productivity
- ▲ For a smooth cut

**NEW**

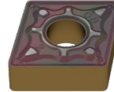

**CTCP135-P**

- ▲ ISO-P35
- ▲ Tough carbide grade for interrupted cuts
- ▲ Guaranteed process security
- ▲ For low cutting speeds and unstable conditions

**DRAGONSKIN**

**NEW**

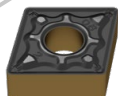

**CTCP125-P**

- ▲ ISO-P25
- ▲ Universal carbide grade for steel machining
- ▲ Excellent balance between toughness and elevated-temperature resistance
- ▲ High level of reliability for machining general steel
- ▲ Excellent for fluctuating cutting conditions, from finishing to roughing

**DRAGONSKIN**

**DRAGONSKIN**



## Test Report

[cuttingtools.ceratizit.com/ie/en/iso-p-grades](http://cuttingtools.ceratizit.com/ie/en/iso-p-grades)

**Insert:** CNMG 120408EN-M50  
**Material:** 1.2343 – X37CrMoV 5-1 44 HRC  
**Cutting data:**  $v_c$  70-130 m/min  
 $f_c$  0.35 mm/rev  
 $a_p$  2 mm

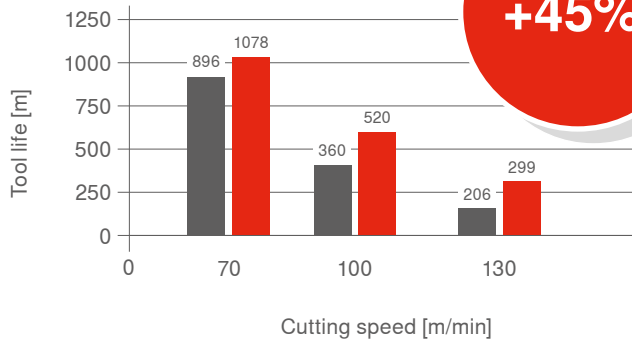

### Performance increase of the new grades:

Cutting speed $v_c$	Increase in %
70 m/min	20
100 m/min	44
130 m/min	45

■ CTCP115 ■ CTCP115-P **NEW**

**Result:** Depending on the cutting speed, an increase in performance of up to **45%** can be achieved with the new CTCP115-P grade.



CTCP115 → 10 cuts



CTCP115-P → 1 cut

Wear detection means that optimum utilisation of the multi-edged indexable insert can be identified with a quick glance at the cutting edges. Wear on the cutting edges is also easier to see and easier for the machine operator to identify.



Further information can be found on → Pages 16–39

DRAGONSKIN



# Stationary 3-jaw chuck

Hotly anticipated – now also for round components



Further information can be found on → Page 62–64

## New SBF-3 stationary 3-jaw chuck from CERATIZIT

Machining round components has become daily routine for many companies. The right clamping system is often a game changer for a successful machining result. CERATIZIT now has a brand-new solution in the portfolio with its SBF-3 stationary 3-jaw chuck – fully compatible with the in-house MNG and PNG zero point clamping systems for rapid, uncomplicated handling.



SBF-3 Ø 200 mm



SBF-3 Ø 315 mm



[cuttingtools.ceratizit.com/ie/en/sbf-3](https://cuttingtools.ceratizit.com/ie/en/sbf-3)



## Technical information – cross-section diagram

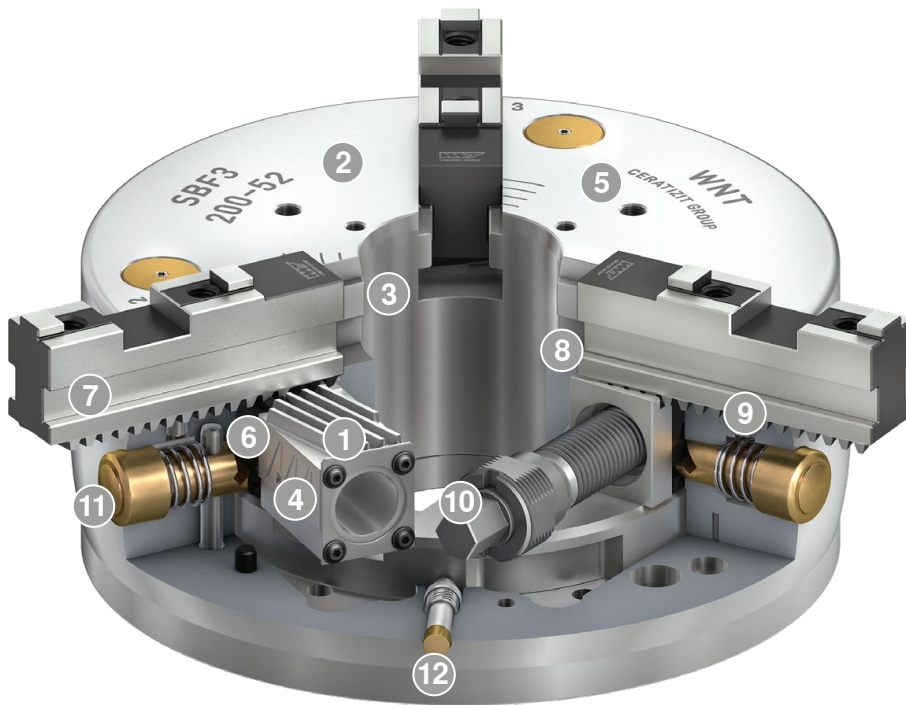

- 1 Wedge bar drive**  
Allows for excellent machining results
- 2 Hardened and extremely stiff base body**  
Longer service life with maximum precision as a result – even at the highest clamping force
- 3 Large through hole**  
For machining all common bar material diameters (optional: enlargement of through hole)
- 4 Optimised lubrication system**  
For high degree of efficiency
- 5 Mounting threads**  
For workpiece stops or cover plates
- 6 Quick jaw change system**  
Single release of jaws, meaning extremely short setup times
- 7 Base jaws with angled teeth (SFG)**
- 8 Locking mechanism**  
Guarantees secure engagement of the base jaw teeth with the wedge bar teeth
- 9 Engagement pin**  
For pre-positioning the base jaw
- 10 Actuation via hex connection**  
Easier operation as a result
- 11 Pushbutton for jaw change**  
For extremely short setup times
- 12 Indicator pin**  
For visual stroke monitoring of the manual clamping chuck

# Turning Holder with DirectCooling system

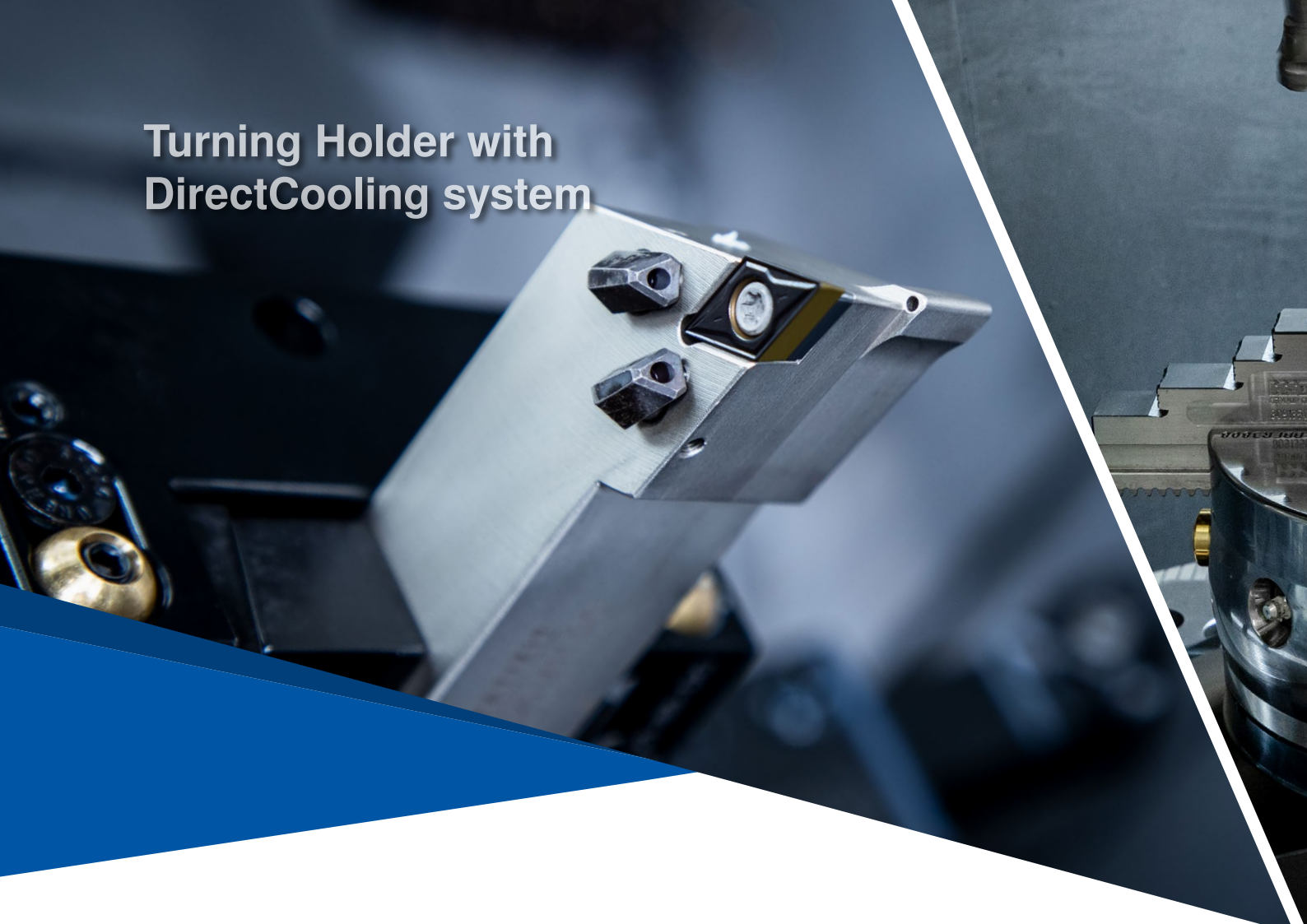

## Table of contents

### KOMET Spindle Tooling

---

12+13 ABS adapters



### Circular and Thread Milling

---

14+15 Type HR thread milling cutter



### Turning Tools

---

16–39 CTCP135-P / CTCP125-P / CTCP115-P with indicator layer

40–55 MaxiLock – S rotating holder with DirectCooling



## Stationary 3-jaw chuck



ISO-P grades with  
indicator layer



## Milling tools with indexable inserts

56 Adjustable angle milling cutter



## Adapters and accessories

58–60 Shell mill adapter SK/BT/HSK-A

61 Hydraulic chuck with ABS connection



## Workpiece clamping

62–64 Stationary 3-jaw chuck

# MicroKom – STM/ABS adapters

- ▲ using this adapter, STM core drilling and precision spindle systems can be accommodated reliably and precisely in ABS base adapters
- ▲ with thro' coolant supply



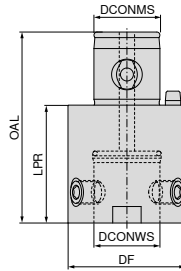

**ABS**

**NEW**



ABS Modular  
**62 359 ...**

Adapter	SZID	DCONWS mm	DCONMS mm	DF mm	LPR mm	OAL mm	EUR W4	
ABS 25	STM 14	14	13	25	30	50	227,30	02590
ABS 32	STM 18	18	16	32	40	63	228,80	03289
ABS 40	STM 22	22	20	40	40	66	261,90	04088
ABS 50	STM 28	28	28	50	50	81	284,20	05097
ABS 63	STM 36	36	34	63	60	98	308,70	06396

 Positioning pin <b>84 950 ...</b>	 Pendulum bolt <b>84 950 ...</b>	 Coolant pipe <b>84 950 ...</b>	 Clamping screw ST <b>62 950 ...</b>
---	--	--	--

Spare parts DCONWS	EUR XX		EUR XX		EUR XX		EUR W7	
14	6,64	23600	31,47	26000	6,70	24400	7,77	027
18	14,63	23700	29,15	26100	6,95	24500	8,31	028
22	14,63	23800	31,52	26200	6,95	24600	9,29	029
28	15,04	20200	36,62	20000	7,52	20100	10,66	030
36	15,55	23900	37,18	26300	7,57	24700	13,65	031

# SpinTools – ABS/STM adapters

- ▲ using this adapter, ABS core drilling and precision spindle systems can be accommodated reliably and precisely in STM base adapters
- ▲ with thro' coolant supply

**STM**

**NEW**

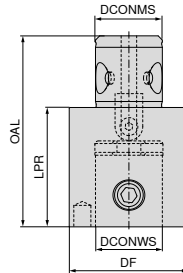

STM Modular  
**62 359 ...**

Adapter	SZID	DCONWS mm	DCONMS mm	DF mm	LPR mm	OAL mm	EUR W4	
STM 14	ABS 25	13	14	25	35	51	227,30	02519
STM 18	ABS 32	16	18	32	40	60	228,80	03218
STM 22	ABS 40	20	22	40	45	69	261,90	04017
STM 28	ABS 50	28	28	50	50	80	284,20	05016
STM 36	ABS 63	34	36	63	60	100	308,70	06315

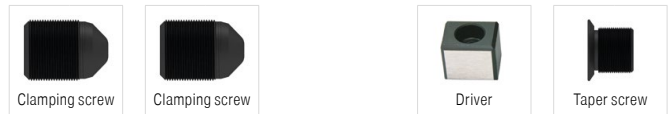

Spare parts	62 950 ...	84 950 ...	62 950 ...	84 950 ...
DCONWS	EUR XX	EUR XX	EUR W7	EUR XX
13		9,84 26800	22,48 036	14,42 27000
16	M8x1x12/SW4 9,84 13989		24,12 037	14,42 27100
20		10,97 26900	27,40 038	14,78 27200
28		12,82 20300	32,20 039	16,43 20400
34		14,11 25500	40,82 040	17,61 27300

# Thread Milling Cutter

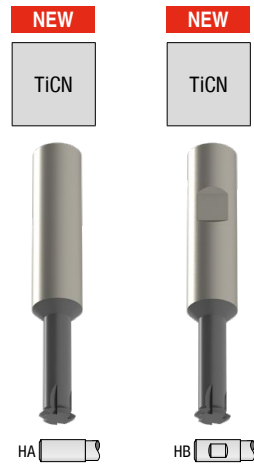
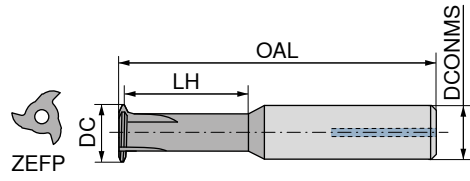
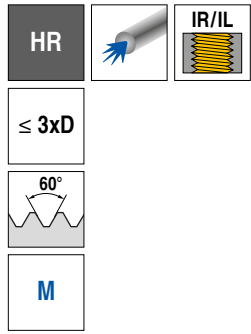

HA Solid carbide HB Solid carbide

DC mm	Thread	TP mm	LH mm	DCONMS <sub>h6</sub> mm	OAL mm	ZEFP
3,14	M4	0,70	9	6	55	3
3,95	M5	0,80	11	6	55	3
4,68	M6 - M7	1,00	16	8	60	3
6,22	M8 - M9	1,25	22	10	71	4
7,79	M10 - M12	1,50	26	10	76	4
9,38	M12	1,75	27	12	86	4

50 546 ...		50 547 ...	
EUR		EUR	
W1		W1	
143,30	04000	145,50	04000
143,30	05000	145,50	05000
146,50	06000	148,80	06000
166,50	08000	167,50	08000
167,50	10000	169,70	10000
186,30	12000	187,30	12000

P	○	○
M	○	○
K	○	○
N	○	○
S	○	○
H	●	●
O	○	○

Other dimensions are available on request.

# Cutting data approximate values

			HR thread milling cutter			
			50 546 ..., 50 547...			
Material sub-group	Index	Tensile strength N/mm <sup>2</sup> / HB / HRC	v <sub>c</sub>	f <sub>z</sub> [mm/tooth]		
			m/min	< Ø 10	> Ø 10	
<b>P</b>	Unalloyed steel	P.1.1	420 N/mm <sup>2</sup> / 125 HB	100	0,025	0,05
		P.1.2	640 N/mm <sup>2</sup> / 190 HB	100	0,025	0,05
		P.1.3	840 N/mm <sup>2</sup> / 250 HB	100	0,025	0,05
		P.1.4	910 N/mm <sup>2</sup> / 270 HB	80	0,015	0,035
		P.1.5	1010 N/mm <sup>2</sup> / 300 HB	80	0,015	0,035
	Low-alloy steel	P.2.1	610 N/mm <sup>2</sup> / 180 HB	100	0,025	0,05
		P.2.2	930 N/mm <sup>2</sup> / 275 HB	80	0,015	0,035
		P.2.3	1010 N/mm <sup>2</sup> / 300 HB	80	0,015	0,035
		P.2.4	1200 N/mm <sup>2</sup> / 375 HB	80	0,015	0,035
	High-alloy steel and high-alloy tool steel	P.3.1	680 N/mm <sup>2</sup> / 200 HB	100	0,025	0,05
		P.3.2	1100 N/mm <sup>2</sup> / 300 HB	80	0,015	0,035
		P.3.3	1300 N/mm <sup>2</sup> / 400 HB	80	0,02	0,04
	Stainless steel	P.4.1	680 N/mm <sup>2</sup> / 200 HB	80	0,02	0,04
		P.4.2	1010 N/mm <sup>2</sup> / 300 HB	80	0,02	0,04
<b>M</b>	Stainless steel	M.1.1	610 N/mm <sup>2</sup> / 180 HB	80	0,02	0,04
		M.2.1	300 HB	80	0,02	0,04
		M.3.1	780 N/mm <sup>2</sup> / 230 HB	80	0,02	0,04
<b>K</b>	Grey cast iron	K.1.1	350 N/mm <sup>2</sup> / 180 HB	120	0,03	0,09
		K.1.2	500 N/mm <sup>2</sup> / 260 HB	120	0,03	0,09
	Spherulitic graphite cast iron	K.2.1	540 N/mm <sup>2</sup> / 160 HB	100	0,02	0,05
		K.2.2	845 N/mm <sup>2</sup> / 250 HB	100	0,02	0,05
	Malleable iron	K.3.1	440 N/mm <sup>2</sup> / 130 HB	100	0,02	0,05
		K.3.2	780 N/mm <sup>2</sup> / 230 HB	100	0,02	0,05
<b>N</b>	Aluminium wrought alloy	N.1.1	60 HB	350	0,05	0,1
		N.1.2	340 N/mm <sup>2</sup> / 100 HB	350	0,05	0,1
	Cast aluminium alloy	N.2.1	250 N/mm <sup>2</sup> / 75 HB	350	0,05	0,1
		N.2.2	300 N/mm <sup>2</sup> / 90 HB	250	0,05	0,1
		N.2.3	440 N/mm <sup>2</sup> / 130 HB	250	0,05	0,1
	Copper and copper alloys (bronze/brass)	N.3.1	375 N/mm <sup>2</sup> / 110 HB	350	0,05	0,1
		N.3.2	300 N/mm <sup>2</sup> / 90 HB	350	0,05	0,1
		N.3.3	340 N/mm <sup>2</sup> / 100 HB	350	0,05	0,1
Magnesium alloys	N.4.1	70 HB	350	0,05	0,1	
<b>S</b>	Heat-resistant alloys	S.1.1	680 N/mm <sup>2</sup> / 200 HB	40	0,02	0,05
		S.1.2	950 N/mm <sup>2</sup> / 280 HB	20	0,02	0,05
		S.2.1	840 N/mm <sup>2</sup> / 250 HB	20	0,02	0,05
		S.2.2	1180 N/mm <sup>2</sup> / 350 HB			
		S.2.3	1080 N/mm <sup>2</sup> / 320 HB			
	Titanium alloys	S.3.1	400 N/mm <sup>2</sup>	100	0,02	0,05
		S.3.2	1050 N/mm <sup>2</sup> / 320 HB	80	0,02	0,05
		S.3.3	1400 N/mm <sup>2</sup> / 410 HB	80	0,02	0,05
<b>H</b>	Hardened steel	H.1.1	46-55 HRC	<b>40</b>	0,008	0,017
		H.1.2	56-60 HRC	<b>25</b>	0,005	0,012
		H.1.3	61-65 HRC			
		H.1.4	66-70 HRC			
	Chilled iron	H.2.1	400 HB	<b>60</b>	0,02	0,04
	Hardened cast iron	H.3.1	55 HRC	<b>25</b>	0,005	0,012
<b>O</b>	Non-metal materials	O.1.1	≤ 150 N/mm <sup>2</sup>	120	0,04	0,1
		O.1.2	≤ 100 N/mm <sup>2</sup>	120	0,04	0,1
		O.2.1	≤ 1000 N/mm <sup>2</sup>	80	0,04	0,1
		O.2.2	≤ 1000 N/mm <sup>2</sup>	80	0,04	0,1
		O.3.1		130	0,04	0,1

\* Tensile strength

## Table of contents

Overview of inserts	16
Indexable inserts, negative	17-29
Indexable inserts, positive	30-37
Technical Information	
Cutting Data	38+39

## CERATIZIT \ Performance

Premium quality tools for high performance.

The premium quality tools from the **CERATIZIT Performance** product line have been designed for specific applications and are distinguished by their outstanding performance. If you make high demands on the performance of your production and want to achieve the very best results, we recommend the Premium tools in this product line.

## Overview of inserts

			Steel	Stainless steel	Cast iron	Non-ferrous metals	Heat-resistant	Tempered steel	Non-metal materials	Geometry								
			P	M	K	N	S	H	O									
		Negative								CC..	DC..	RC..	SC..	SP..	TC..	TP..	VC..	WC..
Fine	-F40		●	○												27		
	-F50		●	○						17	20		22	25	27	28		
	-TFQ		●	○	○					17	20							28
Medium	-XU		●	○						18	20					27	28	
	-M40		●	○											27			
	-M50		●	○	○					18	21		22	25	27	29		
	-TMQ		●	○						18	21							29
	-M70		●	○	○					18	21		22+23	26				29
Rough	-R28		●	○	○					19	21		23	26				
	-R58		●	○	○					19	21		24	26				

			P	M	K	N	S	H	O	Geometry								
		Positive								CC..	DC..	RC..	SC..	SP..	TC..	TP..	VC..	WC..
Fine	-SF		●	○	○					30	32		35		36			37
Medium	-SMF		●	○	○					30	32		35		36			37
	-SM		●	○	●					31	33	34	35		36			37
	-SMQ		●	○						31	33							



### CNMG / CNMM

Designation	L mm	S mm	D1 mm	IC mm
CNMG 0903..	9,7	3,18	3,81	9,52
CNM. 1204..	12,9	4,76	5,16	12,70
CNM. 1606..	16,1	6,35	6,35	15,87
CNM. 1906..	19,3	6,35	7,94	19,05
CNMM 2509..	25,8	9,52	9,12	25,40

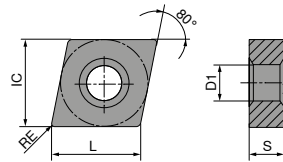

### CNMG

ISO	RE mm	NEW -F50 CTCP115-P		NEW -F50 CTCP125-P		NEW -F50 CTCP135-P		NEW -TFQ CTCP115-P		NEW -TFQ CTCP125-P	
		EUR	IC	EUR	IC	EUR	IC	EUR	IC	EUR	IC
090304EN	0,4	7,79	31601	7,82	51601	7,79	71601				
090308EN	0,8	7,79	31801	7,82	51801	7,79	71801				
120404EN	0,4	11,99	32801	11,99	52801	11,99	72801	13,74	32801	13,74	52801
120408EN	0,8	11,99	33001	11,99	53001	11,99	73001	13,74	33001	13,74	53001
120412EN	1,2	11,99	33201	11,99	53201	11,99	73201	13,74	32001	13,74	53201
P		●		●		●		●		●	
M						○					
K		○		○		○		○		○	
N											
S											
H											
O											

### CNMG

		NEW		NEW		NEW		NEW		NEW		NEW			
		-XU CTCP115-P		-XU CTCP125-P		-M50 CTCP115-P		-M50 CTCP125-P		-M50 CTCP135-P		-TMQ CTCP115-P		-TMQ CTCP125-P	
		DRAGONSKIN		DRAGONSKIN		DRAGONSKIN		DRAGONSKIN		DRAGONSKIN		DRAGONSKIN		DRAGONSKIN	
		M CNMG		M CNMG		M CNMG		M CNMG		M CNMG		M CNMG		M CNMG	
		76 290 ...		76 290 ...		76 135 ...		76 135 ...		76 135 ...		76 196 ...		76 196 ...	
ISO	RE mm	EUR 1A/08		EUR 1A/08		EUR 1A/08		EUR 1A/08		EUR 1A/08		EUR 1A/08		EUR 1A/08	
120404EN	0,4	12,03	32801	12,03	52801	11,99	32801	11,99	52801	11,99	72801				
120408EN	0,8	12,03	33001	12,03	53001	11,99	33001	11,99	53001	11,99	73001			13,74	53001
120412EN	1,2	12,03	33201	12,03	53201	11,99	32001	11,99	53201	11,99	73201	13,74	32001	13,74	53201
120416EN	1,6					11,99	33401	11,99	53401	11,99	73401				
160608EN	0,8					19,38	34201	19,38	54201	19,38	74201				
160612EN	1,2					19,38	34401	19,38	54401	19,38	74401				
160616EN	1,6					19,38	34601	19,38	54601	19,38	74601				
P			•		•		•		•		•		•		•
M											○				
K			○		○		○		○				○		○
N															
S															
H															
O															

### CNMG

		NEW		NEW		NEW	
		-M70 CTCP115-P		-M70 CTCP125-P		-M70 CTCP135-P	
		DRAGONSKIN		DRAGONSKIN		DRAGONSKIN	
		M CNMG		M CNMG		M CNMG	
		76 119 ...		76 119 ...		76 119 ...	
ISO	RE mm	EUR 1A/08		EUR 1A/08		EUR 1A/08	
120408EN	0,8	11,99	33001	11,99	53001	11,99	73001
120412EN	1,2	11,99	32001	11,99	53201	11,99	73201
120416EN	1,6	11,99	33401	11,99	53401	11,99	73401
160608EN	0,8	19,38	34201	19,38	54201	19,38	74201
160612EN	1,2	19,38	34401	19,38	54401	19,38	74401
160616EN	1,6	19,38	34601	19,38	54601	19,38	74601
160624EN	2,4	19,38	34801	19,38	54801	19,38	74801
190608EN	0,8	27,37	35401	27,37	55401	27,37	75401
190612EN	1,2	27,37	35601	27,37	55601	27,37	75601
190616EN	1,6	27,37	35801	27,37	55801	27,37	75801
190624EN	2,4	27,37	36001	27,37	56001	27,37	76001
P			•		•		•
M							○
K			○		○		
N							
S							
H							
O							

# CNMM



ISO	RE mm	76 114 ...		76 114 ...		76 114 ...		76 115 ...		76 115 ...		76 115 ...	
		EUR 1A/08		EUR 1A/08		EUR 1A/08		EUR 1A/08		EUR 1A/08		EUR 1A/08	
120408EN	0,8	12,21	33001	12,21	53001			12,21	33001	12,21	53001	12,21	73001
120412EN	1,2	12,21	33201	12,21	53201	12,21	73201	12,21	33201	12,21	53201	12,21	73201
120416EN	1,6	12,21	33401	12,21	53401	12,21	73401	12,21	33401	12,21	53401	12,21	73401
160612EN	1,2	19,38	34401	19,38	54401	19,38	74401	19,38	34401	19,38	54401	19,38	74401
160616EN	1,6	19,38	34601	19,38	54601	19,38	74601	19,38	34601	19,38	54601	19,38	74601
160624EN	2,4							19,38	34801	19,38	54801	19,38	74801
190612EN	1,2	27,37	35601	27,37	55601	27,37	75601	27,37	35601	27,37	55601	27,37	75601
190616EN	1,6	27,37	35801	27,37	55801	27,37	75801	27,37	35801	27,37	55801	27,37	75801
190624EN	2,4	27,37	36001	27,37	56001	27,37	76001	27,37	36001	27,37	52401	27,37	76001
250924EN	2,4	63,19	38401	63,19	58401	63,19	78401	63,19	38401	63,19	58401	63,19	78401
P			●		●		●		●		●		●
M							○						○
K			○		○				○		○		○
N													
S													
H													
O													

## DNMG / DNMM

Designation	L mm	S mm	D1 mm	IC mm
DNMG 1104..	11,6	4,76	3,81	9,52
DNMG 1504..	15,5	4,76	5,16	12,70
DNM. 1506..	15,5	6,35	5,16	12,70

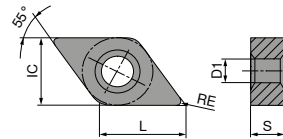

## DNMG

		NEW		NEW		NEW		NEW		NEW		NEW	
		-F50		-F50		-F50		-TFQ		-TFQ		-XU	
		CTCP115-P		CTCP125-P		CTCP135-P		CTCP115-P		CTCP125-P		CTCP115-P	
		DRAGONSKIN		DRAGONSKIN		DRAGONSKIN		DRAGONSKIN		DRAGONSKIN		DRAGONSKIN	
		F		F		F		F		F		M	
		DNMG		DNMG		DNMG		DNMG		DNMG		DNMG	
		76 134 ...		76 134 ...		76 134 ...		76 153 ...		76 153 ...		76 291 ...	
ISO	RE mm	EUR 1A/08		EUR 1A/08		EUR 1A/08		EUR 1A/08		EUR 1A/08		EUR 1A/08	
110402EN	0,2	12,80	30201	12,80	50201	12,80	70201						
110404EN	0,4	12,80	30401	12,80	50401	12,80	70401						
110408EN	0,8	12,80	30601	12,80	50601	12,80	70601						
110412EN	1,2	12,80	30801	12,80	50801	12,80	70801						
150404EN	0,4	15,51	31601	15,51	51601	15,51	71601						
150408EN	0,8	15,51	31801	15,51	51801	15,51	71801						
150412EN	1,2	15,51	32001	15,51	52001	15,51	72001						
150604EN	0,4	16,80	32801	16,80	52801	16,80	72801	19,38	32801	19,38	52801	16,80	32801
150608EN	0,8	16,80	33001	16,80	53001	16,80	73001	19,38	33001	19,38	53001	16,80	33001
150612EN	1,2	16,80	33201	16,80	53201	16,80	73201					16,80	33201
P			•		•		•		•		•		•
M							○						
K			○		○				○		○		○
N													
S													
H													
O													

### DNMG

		NEW		NEW		NEW		NEW		NEW		NEW	
		-M50		-M50		-M50		-TMQ		-M70		-M70	
		CTCP115-P		CTCP125-P		CTCP135-P		CTCP125-P		CTCP115-P		CTCP125-P	
		DRAGONSKIN		DRAGONSKIN		DRAGONSKIN		DRAGONSKIN		DRAGONSKIN		DRAGONSKIN	
		M		M		M		M		M		M	
		DNMG		DNMG		DNMG		DNMG		DNMG		DNMG	
		76 136 ...		76 136 ...		76 136 ...		76 197 ...		76 263 ...		76 263 ...	
ISO	RE mm	EUR		EUR		EUR		EUR		EUR		EUR	
		1A/08		1A/08		1A/08		1A/08		1A/08		1A/08	
110404EN	0,4	12,80	30401	12,80	50401	12,80	70401						
110408EN	0,8	12,80	30601	12,80	50601	12,80	70601		12,80	30601	12,80	50601	12,80
110412EN	1,2	12,80	30801	12,80	50801	12,80	70801		12,80	30801	12,80	50801	12,80
150404EN	0,4	15,51	31601	15,51	51401	15,51	71601						
150408EN	0,8	15,51	31801	15,51	51801	15,51	71801		15,51	31801	15,51	51801	15,51
150412EN	1,2	15,51	32001	15,51	51601	15,51	72001		15,51	32001	15,51	52001	15,51
150416EN	1,6	15,51	32201	15,51	52201	15,51	72201		15,51	32201	15,51	52201	15,51
150604EN	0,4	16,80	32801	16,80	52801	16,80	72801						
150608EN	0,8	16,80	33001	16,80	53001	16,80	73001	19,38	53001	16,80	33001	16,80	53001
150612EN	1,2	16,80	33201	16,80	53201	16,80	73201	19,38	53201	16,80	33201	16,80	53201
150616EN	1,6	16,80	33401	16,80	53401	16,80	73401			16,80	33401	16,80	53401
P			•		•		•		•		•		•
M							○						○
K			○		○				○		○		○
N													
S													
H													
O													

### DNMM

		NEW		NEW		NEW		NEW		NEW		NEW	
		-R28		-R28		-R28		-R58		-R58		-R58	
		CTCP115-P		CTCP125-P		CTCP135-P		CTCP115-P		CTCP125-P		CTCP135-P	
		DRAGONSKIN		DRAGONSKIN		DRAGONSKIN		DRAGONSKIN		DRAGONSKIN		DRAGONSKIN	
		R		R		R		R		R		R	
		DNMM		DNMM		DNMM		DNMM		DNMM		DNMM	
		76 165 ...		76 165 ...		76 165 ...		76 166 ...		76 166 ...		76 166 ...	
ISO	RE mm	EUR		EUR		EUR		EUR		EUR		EUR	
		1A/08		1A/08		1A/08		1A/08		1A/08		1A/08	
150612EN	1,2	16,80	33201	16,80	53201	16,80	73201	16,80	33201	16,80	53201	16,80	73201
150616EN	1,6	16,80	33401	16,80	53401	16,80	73401	16,80	33401	16,80	53401	16,80	73401
P			•		•		•		•		•		•
M							○						○
K			○		○				○		○		○
N													
S													
H													
O													

# SNMG / SNMM

Designation	L mm	S mm	D1 mm	IC mm
SNMG 0903..	9,52	3,18	3,81	9,52
SNM. 1204..	12,70	4,76	5,16	12,70
SNM. 1506..	15,87	6,35	6,35	15,87
SNM. 1906..	19,05	6,35	7,94	19,05
SNMM 2507..	25,40	7,94	9,12	25,40
SNMM 2509..	25,40	9,52	9,12	25,40

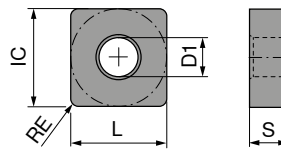

# SNMG

ISO	RE mm	NEW -F50 CTCP115-P		NEW -F50 CTCP125-P		NEW -F50 CTCP135-P		NEW -M50 CTCP115-P		NEW -M50 CTCP125-P		NEW -M50 CTCP135-P		NEW -M70 CTCP115-P	
		DRAGONSKIN	DRAGONSKIN	DRAGONSKIN	DRAGONSKIN	DRAGONSKIN	DRAGONSKIN	DRAGONSKIN	DRAGONSKIN	DRAGONSKIN	DRAGONSKIN	DRAGONSKIN	DRAGONSKIN	DRAGONSKIN	
		F	F	F	M	M	M	M	M	M	M	M	M		
		SNMG	SNMG	SNMG	SNMG	SNMG	SNMG	SNMG	SNMG	SNMG	SNMG	SNMG	SNMG		
		76 140 ...	76 140 ...	76 140 ...	76 137 ...	76 137 ...	76 137 ...	76 137 ...	76 137 ...	76 137 ...	76 137 ...	76 225 ...			
		EUR	EUR	EUR	EUR	EUR	EUR	EUR	EUR	EUR	EUR	EUR			
		1A/08	1A/08	1A/08	1A/08	1A/08	1A/08	1A/08	1A/08	1A/08	1A/08	1A/08			
090308EN	0,8	7,79	30601	7,79	50601	7,79	70601								
120404EN	0,4	12,21	31601	12,21	51601	12,21	71601								
120408EN	0,8	12,21	31801	12,21	51801	12,21	71801	12,21	31801	12,21	51801	12,21	71801	12,21	31801
120412EN	1,2	12,21	32001	12,21	52001	12,21	72001	12,21	32001	12,21	52001	12,21	72001	12,21	32001
120416EN	1,6							12,21	32201	12,21	52201	12,21	72201	12,21	32201
150608EN	0,8							19,38	53001	19,38	73001				
150608EN	1,6							19,38	33001						
150612EN	1,2							19,38	33201	19,38	53201	19,38	73201	19,38	33201
150616EN	1,6							19,38	33401	19,38	53401	19,38	73401	19,38	33401
190612EN	1,2													27,37	34401
190616EN	1,6													27,37	34601
190624EN	2,4													27,37	34801
P			●		●		●		●		●		●		●
M							○						○		
K			○		○				○		○				○
N															
S															
H															
O															

# SNMG / SNMM

		NEW -M70 CTCP125-P		NEW -M70 CTCP135-P		NEW -R28 CTCP115-P		NEW -R28 CTCP125-P		NEW -R28 CTCP135-P	
		DRAGONSKIN		DRAGONSKIN		DRAGONSKIN		DRAGONSKIN		DRAGONSKIN	
		M SNMG		M SNMG		R SNMM		R SNMM		R SNMM	
		76 225 ...		76 225 ...		76 128 ...		76 128 ...		76 128 ...	
ISO	RE mm	EUR 1A/08		EUR 1A/08		EUR 1A/08		EUR 1A/08		EUR 1A/08	
120408EN	0,8	12,21	51801	12,21	71801						
120412EN	1,2	12,21	52001	12,21	72001						
120416EN	1,6	12,21	52201	12,21	72201						
150612EN	1,2	19,38	53201	19,38	73201	19,38	33201	19,38	53201	19,38	73201
150616EN	1,6	19,38	53401	19,38	73401	19,38	33401	19,38	53401	19,38	73401
190612EN	1,2	27,37	54401	27,37	74401						
190616EN	1,6	27,37	54601	27,37	74601	27,37	34601	27,37	54601	27,37	74601
190624EN	2,4	27,37	54801	27,37	74801						
250724EN	2,4									53,80	76001
250924EN	2,4					63,19	37001	63,19	57001	63,19	77001
P			●		●		●		●		●
M					○						○
K			○				○		○		
N											
S											
H											
O											

# SNMM

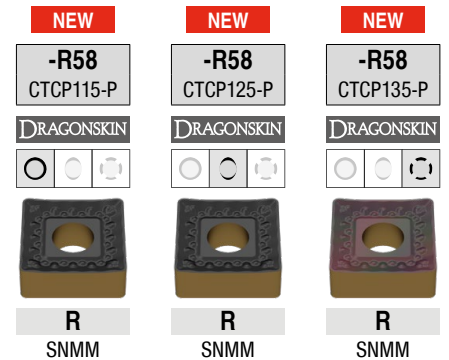

ISO	RE mm	76 129 ...		76 129 ...		76 129 ...	
		EUR 1A/08		EUR 1A/08		EUR 1A/08	
120408EN	0,8	12,21	31801	12,21	51801	12,21	71801
120412EN	1,2	12,21	32001	12,21	52001	12,21	72001
150612EN	1,2	19,38	33201	19,38	53201	19,38	73201
150616EN	1,6	19,38	33401	19,38	53401	19,38	73401
190612EN	1,2	27,37	34401	27,37	54401	27,37	74401
190616EN	1,6	27,37	34601	27,37	54601	27,37	74601
190624EN	2,4	27,37	34801	27,37	54801	27,37	74801
250724EN	2,4	53,80	36001	53,80	56001	53,80	76001
250924EN	2,4	63,19	37001	63,19	57001	63,19	77001
P			●		●		●
M							○
K			○		○		
N							
S							
H							
O							



## TNMG / TNMM

Designation	L mm	S mm	D1 mm	IC mm
TNMG 1103..	11,0	3,18	2,26	6,35
TNMG 1604..	16,5	4,76	3,81	9,52
TNM. 2204..	22,0	4,76	5,16	12,70

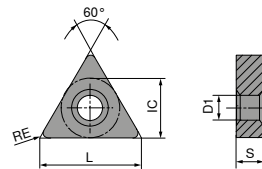

## TNMG

ISO	RE mm	NEW -F50 CTCP115-P		NEW -F50 CTCP125-P		NEW -F50 CTCP135-P		NEW -M50 CTCP115-P		NEW -M50 CTCP125-P		NEW -M50 CTCP135-P	
		DRAGONSKIN	DRAGONSKIN	DRAGONSKIN	DRAGONSKIN	DRAGONSKIN	DRAGONSKIN	DRAGONSKIN	DRAGONSKIN	DRAGONSKIN	DRAGONSKIN	DRAGONSKIN	DRAGONSKIN
		F TNMG 76 146 ...		F TNMG 76 146 ...		F TNMG 76 146 ...		M TNMG 76 138 ...		M TNMG 76 138 ...		M TNMG 76 138 ...	
		EUR 1A/08		EUR 1A/08		EUR 1A/08		EUR 1A/08		EUR 1A/08		EUR 1A/08	
110304EN	0,4	6,76	30401	6,76	50401	6,76	70401						
110308EN	0,8	6,76	30601	6,76	50601	6,76	70601						
160404EN	0,4	10,71	31601	10,71	51601	10,71	71601	10,71	31601	10,71	51601	10,71	71601
160408EN	0,8	10,71	31801	10,71	51801	10,71	71801	10,71	31801	10,71	51801	10,71	71801
160412EN	1,2	10,71	32001	10,71	52001	10,71	72001	10,71	32001	10,71	52001	10,71	72001
220408EN	0,8							14,45	33001	14,45	53001	14,45	73001
220412EN	1,2							14,45	33201	14,45	53201	14,45	73201
P			●		●		●		●		●		●
M							○						○
K			○		○				○		○		
N													
S													
H													
O													

# TNMG

ISO	RE mm	NEW -M70 CTCP115-P		NEW -M70 CTCP125-P		NEW -M70 CTCP135-P		NEW CTCP125-P	
		76 155 ...	EUR 1A/08	76 155 ...	EUR 1A/08	76 155 ...	EUR 1A/08	76 142 ...	EUR 1A/08
160404ER	0,4								
160408EL	0,8							10,71	51601
160408EN	0,8	10,71	31801	10,71	51801	10,71	71801		
160408ER	0,8							10,71	51801
160412EN	1,2	10,71	32001	10,71	52001	10,71	72001		
220404EN	0,4			14,45	52801				
220408EN	0,8	14,45	33001	14,45	53001	14,45	73001		
220412EN	1,2	14,45	33201	14,45	53201	14,45	73201		
220416EN	1,6	14,45	33401	14,45	53401	14,45	73401		
P			●		●		●		●
M							○		
K			○		○				○
N									
S									
H									
O									

# TNMM

ISO	RE mm	NEW -R28 CTCP115-P		NEW -R28 CTCP125-P		NEW -R28 CTCP135-P		NEW -R58 CTCP115-P		NEW -R58 CTCP125-P		NEW -R58 CTCP135-P	
		76 154 ...	EUR 1A/08	76 154 ...	EUR 1A/08	76 154 ...	EUR 1A/08	76 152 ...	EUR 1A/08	76 152 ...	EUR 1A/08	76 152 ...	EUR 1A/08
220412EN	1,2							14,45	33201	14,45	53201	14,45	73201
220416EN	1,6	14,45	33401	14,45	53401	14,45	73401						
P			●		●		●		●		●		●
M							○						○
K			○		○				○		○		
N													
S													
H													
O													

### VNMG

Designation	L mm	S mm	D1 mm	IC mm
VNMG 1604..	16,6	4,76	3,81	9,52

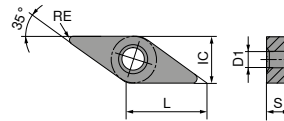

### VNMG

NEW	NEW	NEW	NEW
<b>-F40</b> CTCP125-P	<b>-F50</b> CTCP115-P	<b>-F50</b> CTCP125-P	<b>-F50</b> CTCP135-P
DRAGONSKIN	DRAGONSKIN	DRAGONSKIN	DRAGONSKIN
<b>F</b> VNMG	<b>F</b> VNMG	<b>F</b> VNMG	<b>F</b> VNMG
<b>76 000 ...</b>	<b>76 156 ...</b>	<b>76 156 ...</b>	<b>76 156 ...</b>
EUR 1A/08	EUR 1A/08	EUR 1A/08	EUR 1A/08
21,61 51601	21,61 31601	21,61 51601	21,61 71601
21,61 51801	21,61 31801	21,61 51801	21,61 71801

ISO	RE mm
160404EN	0,4
160408EN	0,8

P	•	•	•	•
M				○
K		○	○	○
N				
S				
H				
O				

### VNMG

NEW	NEW	NEW	NEW	NEW
<b>-XU</b> CTCP115-P	<b>-XU</b> CTCP125-P	<b>-M40</b> CTCP125-P	<b>-M50</b> CTCP115-P	<b>-M50</b> CTCP125-P
DRAGONSKIN	DRAGONSKIN	DRAGONSKIN	DRAGONSKIN	DRAGONSKIN
<b>M</b> VNMG	<b>M</b> VNMG	<b>M</b> VNMG	<b>M</b> VNMG	<b>M</b> VNMG
<b>76 294 ...</b>	<b>76 294 ...</b>	<b>76 001 ...</b>	<b>76 131 ...</b>	<b>76 131 ...</b>
EUR 1A/08	EUR 1A/08	EUR 1A/08	EUR 1A/08	EUR 1A/08
21,57 31601	21,57 51601	21,61 51601	21,61 31601	21,61 51601
21,57 31801	21,57 51801	21,61 51801	21,61 31801	21,61 51801
			21,61 32001	21,61 52001

ISO	RE mm
160404EN	0,4
160408EN	0,8
160408EN	0,4
160412EN	1,2

P	•	•	•	•
M				
K		○	○	○
N				
S				
H				
O				

### WNMG

Designation	L mm	S mm	D1 mm	IC mm
WNMG 0604..	6,5	4,76	3,81	9,52
WNMG 0804..	8,6	4,76	5,16	12,70

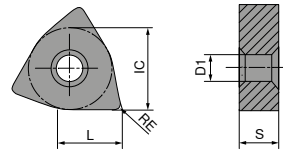

### WNMG

		NEW		NEW		NEW		NEW		NEW		NEW	
		-F50		-F50		-F50		-TFQ		-TFQ		-XU	
		CTCP115-P		CTCP125-P		CTCP135-P		CTCP115-P		CTCP125-P		CTCP115-P	
		DRAGONSKIN		DRAGONSKIN		DRAGONSKIN		DRAGONSKIN		DRAGONSKIN		DRAGONSKIN	
		F		F		F		F		M		M	
		WNMG		WNMG		WNMG		WNMG		WNMG		WNMG	
		76 157 ...		76 157 ...		76 157 ...		76 177 ...		76 177 ...		76 295 ...	
ISO	RE mm	EUR 1A/08		EUR 1A/08		EUR 1A/08		EUR 1A/08		EUR 1A/08		EUR 1A/08	
060404EN	0,4	10,45	30401	10,45	50401	10,45	70401	12,10	30401	12,10	51401		
060408EN	0,8	10,45	30601	10,45	50601	10,45	70601	12,10	30601	12,10	50601		
080404EN	0,4	13,16	31601	13,16	51601	13,16	71601			13,17	31601	13,17	51601
080408EN	0,8	13,16	31801	13,16	51801	13,16	71801	15,14	31801	15,14	51801	13,17	51801
080412EN	1,2	13,16	32001	13,16	52001	13,16	72001	15,14	32001	15,14	52001	13,17	52001
P			●		●		●		●		●		●
M							○						
K			○		○				○		○		○
N													
S													
H													
O													

### WNMG

		NEW -M50 CTCP115-P		NEW -M50 CTCP125-P		NEW -M50 CTCP135-P		NEW -TMQ CTCP115-P		NEW -TMQ CTCP125-P	
		DRAGONSKIN		DRAGONSKIN		DRAGONSKIN		DRAGONSKIN		DRAGONSKIN	
		M WNMG		M WNMG		M WNMG		M WNMG		M WNMG	
		76 139 ...		76 139 ...		76 139 ...		76 198 ...		76 198 ...	
ISO	RE mm	EUR 1A/08		EUR 1A/08		EUR 1A/08		EUR 1A/08		EUR 1A/08	
060404EN	0,4	10,45	30401	10,45	50401	10,45	70401				
060408EN	0,8	10,45	30601	10,45	50601	10,45	70601				
060412EN	1,2	10,45	30801	10,45	50801	10,45	70801				
080404EN	0,4	13,16	31601	13,16	51601	13,16	71601				
080408EN	0,8	13,16	31801	13,16	51801	13,16	71801	15,14	31801	15,14	51801
080412EN	1,2	13,16	32001	13,16	52001	13,16	72001	15,14	32001	15,14	52001
080416EN	1,6	13,16	32201	13,16	52201	13,16	72201				
P			●		●		●		●		●
M							○				
K			○		○				○		○
N											
S											
H											
O											

### WNMG

		NEW -M70 CTCP115-P		NEW -M70 CTCP125-P		NEW -M70 CTCP135-P	
		DRAGONSKIN		DRAGONSKIN		DRAGONSKIN	
		M WNMG		M WNMG		M WNMG	
		76 273 ...		76 273 ...		76 273 ...	
ISO	RE mm	EUR 1A/08		EUR 1A/08		EUR 1A/08	
060408EN	0,8	10,45	30601	10,45	50601	10,45	70601
060412EN	1,2	10,45	30801	10,45	50801	10,45	70801
080408EN	0,8	13,16	31801	13,16	51801	13,16	71801
080412EN	1,2	13,16	32001	13,16	52001	13,16	72001
080416EN	1,6	13,16	32201	13,16	52201	13,16	72201
P			●		●		●
M							○
K			○		○		
N							
S							
H							
O							

# CCGT / CCMT

Designation	L mm	S mm	D1 mm	IC mm
CC.T 0602..	6,4	2,38	2,8	6,35
CCMT 09T3..	9,7	3,97	4,4	9,52
CCMT 09T3..	9,7	9,70	4,4	9,52
CCMT 1204..	12,9	4,76	5,5	12,70
CCMT 1204..	12,9	12,90	5,5	12,70

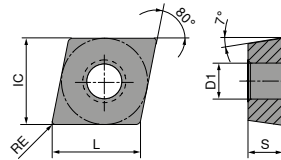

# CCGT / CCMT

ISO	RE mm	NEW -SF CTCP125-P		NEW -SF CTCP135-P		NEW -SF CTCP115-P		NEW -SF CTCP125-P		NEW -SF CTCP135-P		NEW -SMF CTCP115-P		NEW -SMF CTCP125-P	
		DRAGONSKIN	DRAGONSKIN	DRAGONSKIN	DRAGONSKIN	DRAGONSKIN	DRAGONSKIN	DRAGONSKIN	DRAGONSKIN	DRAGONSKIN	DRAGONSKIN	DRAGONSKIN	DRAGONSKIN	DRAGONSKIN	DRAGONSKIN
		F CCGT		F CCGT		F CCMT		F CCMT		F CCMT		F CCMT		F CCMT	
		76 251 ...		76 251 ...		76 253 ...		76 253 ...		76 253 ...		76 249 ...		76 249 ...	
		EUR 1A/08		EUR 1A/08		EUR 1A/08		EUR 1A/08		EUR 1A/08		EUR 1A/08		EUR 1A/08	
060202EN	0,2	14,55	50201	14,55	70201										
060204EN	0,4			8,17	30401	8,17	50401	8,17	70401					8,17	50401
060208EN	0,8													8,17	50601
09T304EN	0,4			10,19	31601	10,19	51601	10,19	71601	10,19	31601	10,19	31601	10,19	51601
09T308EN	0,8			10,19	31801	10,19	51801			10,19	31801	10,19	31801	10,19	51801
120404EN	0,4					14,34	52801							14,34	52801
120408EN	0,8					14,34	53001			14,34	33001				
P			●		●		●		●		●		●		●
M					○						○				
K			○				○		○				○		○
N															
S															
H															
O															

# CCMT / CCGT

		NEW -SMF CTCP135-P	NEW -SM CTCP125-P	NEW -SM CTCP135-P	NEW -SM CTCP115-P	NEW -SM CTCP125-P	NEW -SM CTCP135-P
		DRAGONSKIN	DRAGONSKIN	DRAGONSKIN	DRAGONSKIN	DRAGONSKIN	DRAGONSKIN
		F CCMT	M CCGT	M CCGT	M CCMT	M CCMT	M CCMT
		76 249 ...	76 250 ...	76 250 ...	76 252 ...	76 252 ...	76 252 ...
ISO	RE mm	EUR 1A/08	EUR 1A/08	EUR 1A/08	EUR 1A/08	EUR 1A/08	EUR 1A/08
060202EN	0,2		14,55 50201	14,55 70201			
060204EN	0,4	8,17 70401			8,17 30401	8,17 50401	8,17 70401
060208EN	0,8				8,17 30601		8,17 70601
09T304EN	0,4	10,19 71601			10,19 31601	10,19 51601	10,19 71601
09T308EN	0,8				10,19 31801	10,19 51801	10,19 71801
120404EN	0,4				14,34 32801	14,34 52801	14,34 72801
120408EN	0,8	14,34 73001			14,34 33001	14,34 53001	14,34 73001
120412EN	1,2				14,34 53201		
P		●	●	●	●	●	●
M		○		○			○
K			○		○	○	
N							
S							
H							
O							

# CCMT

		NEW -SMQ CTCP115-P	NEW -SMQ CTCP125-P
		DRAGONSKIN	DRAGONSKIN
		F CCMT	F CCMT
		76 194 ...	76 194 ...
ISO	RE mm	EUR 1A/08	EUR 1A/08
09T304EN	0,4	11,46 31601	11,46 51601
09T308EN	0,8	11,46 31801	11,46 51801
120404EN	0,4	16,10 32801	16,10 52801
120408EN	0,8	16,10 33001	16,10 53001
P		●	●
M			
K		○	○
N			
S			
H			
O			

### DCGT / DCMT

Designation	L mm	S mm	D1 mm	IC mm
DC.T 0702..	7,75	2,38	2,8	6,35
DCMT 11T3..	11,60	3,97	4,4	9,52

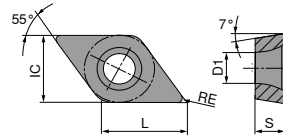

### DCGT / DCMT

		NEW		NEW		NEW		NEW		NEW		NEW			
		-SF CTCP125-P		-SF CTCP115-P		-SF CTCP125-P		-SF CTCP135-P		-SMF CTCP115-P		-SMF CTCP125-P		-SMF CTCP135-P	
		DRAGONSKIN		DRAGONSKIN		DRAGONSKIN		DRAGONSKIN		DRAGONSKIN		DRAGONSKIN		DRAGONSKIN	
		F DCGT		F DCMT		F DCMT		F DCMT		F DCMT		F DCMT		F DCMT	
		76 257 ...		76 259 ...		76 259 ...		76 259 ...		76 265 ...		76 265 ...		76 265 ...	
ISO	RE mm	EUR 1A/08	EUR 1A/08	EUR 1A/08	EUR 1A/08	EUR 1A/08	EUR 1A/08	EUR 1A/08	EUR 1A/08	EUR 1A/08	EUR 1A/08	EUR 1A/08	EUR 1A/08	EUR 1A/08	EUR 1A/08
070202EN	0,2	14,55	50201												
070204EN	0,4			8,17	30401	8,17	50401	8,17	70401			8,17	50401	8,17	70401
070208EN	0,8													8,17	70601
11T304EN	0,4			11,48	31601	11,48	51601	11,48	71601	11,48	31601	11,48	51601	11,48	71601
11T308EN	0,8			11,48	31801	11,48	51801	11,48	71801	11,48	31801	11,48	51801	11,48	71801
P			●	●	●	●	●	●	●	●	●	●	●	●	●
M									○						○
K			○	○	○	○	○	○	○	○	○	○	○	○	○
N															
S															
H															
O															



# DCGT / DCMT

		NEW		NEW		NEW		NEW		NEW		NEW	
		-SM		-SM		-SM		-SM		-SMQ		-SMQ	
		CTCP125-P		CTCP135-P		CTCP115-P		CTCP125-P		CTCP135-P		CTCP115-P	
		DRAGONSKIN		DRAGONSKIN		DRAGONSKIN		DRAGONSKIN		DRAGONSKIN		DRAGONSKIN	
		M		M		M		M		M		M	
		DCGT		DCGT		DCMT		DCMT		DCMT		DCMT	
		76 256 ...		76 256 ...		76 258 ...		76 258 ...		76 258 ...		76 195 ...	
ISO	RE	EUR		EUR		EUR		EUR		EUR		EUR	
	mm	1A/08		1A/08		1A/08		1A/08		1A/08		1A/08	
070202EN	0,2	14,55	50201	14,55	70201								
070204EN	0,4					8,17	30401	8,17	50401	8,17	70401	9,31	30401
070208EN	0,8					8,17	30601	8,17	50601	8,17	70601		
11T304EL	0,4											12,80	51601
11T304EN	0,4							11,48	51601	11,48	71601	12,80	51501
11T304EN	0,4					11,48	31601						
11T304ER	0,4											12,80	51701
11T308EN	0,8					11,48	31801	11,48	51801	11,48	71801	12,80	51801
11T312EN	1,2							11,48	52001				
P			•		•		•		•		•		•
M					○						○		
K			○				○		○			○	○
N													
S													
H													
O													

## RCMT / RCGT

Designation	S mm	D1 mm	IC mm
RCGT 0602..	2,38	2,8	6
RCGT 0803..	3,18	3,4	8
RCMT 1003..	3,18	4,0	10
RCMT 1204..	4,76	4,9	12
RCMT 1606..	6,35	5,3	16
RCMT 2006..	6,35	6,5	20
RCMT 2507..	7,94	7,2	25

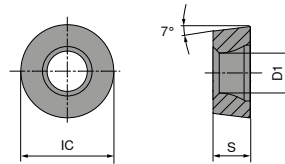

## RCMT / RCGT

ISO	RE mm	NEW -SM CTCP115-P DRAGONSKIN		NEW -SM CTCP125-P DRAGONSKIN		NEW -SM CTCP125-P DRAGONSKIN		NEW -SM CTCP135-P DRAGONSKIN		NEW -SM CTCP135-P DRAGONSKIN	
		M	RCMT	M	RCGT	M	RCMT	M	RCGT	M	RCMT
		<b>76 264 ...</b>	<b>EUR 1A/08</b>	<b>76 262 ...</b>	<b>EUR 1A/08</b>	<b>76 264 ...</b>	<b>EUR 1A/08</b>	<b>76 262 ...</b>	<b>EUR 1A/08</b>	<b>76 264 ...</b>	<b>EUR 1A/08</b>
0602M0EN	3,0			8,47	50201			8,47	70201		
0803M0EN	4,0			9,44	51201			9,44	71201		
1003M0SN	5,0					8,17	51401			8,17	71401
1204M0SN	6,0	9,68	32801			9,68	52601			9,68	72601
1606M0SN	8,0	19,04	34001			19,04	53801			19,04	73801
2006M0SN	10,0					26,20	55001			26,20	75001
2507M0SN	12,5	42,19	36201			42,19	56201			42,19	76201
P		●		●		●		●		●	
M								○		○	
K		○		○		○					
N											
S											
H											
O											

### SCMT

Designation	L mm	S mm	D1 mm	IC mm
SCMT 09T3..	9,52	3,97	4,4	9,52
SCMT 1204..	12,70	4,76	5,5	12,70

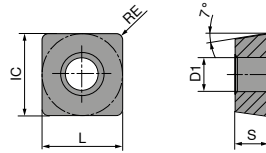

### SCMT

ISO	RE mm	NEW -SF CTCP125-P		NEW -SMF CTCP115-P		NEW -SMF CTCP135-P		NEW -SM CTCP115-P		NEW -SM CTCP125-P		NEW -SM CTCP135-P	
		DRAGONSKIN		DRAGONSKIN		DRAGONSKIN		DRAGONSKIN		DRAGONSKIN		DRAGONSKIN	
		F SCMT		F SCMT		F SCMT		M SCMT		M SCMT		M SCMT	
		76 269 ...		76 267 ...		76 267 ...		76 268 ...		76 268 ...		76 268 ...	
		EUR 1A/08		EUR 1A/08		EUR 1A/08		EUR 1A/08		EUR 1A/08		EUR 1A/08	
09T304EN	0,4	10,19	50401	10,19	30401			10,19	30401	10,19	50401	10,19	70401
09T308EN	0,8	10,19	50601	10,19	30601			10,19	30601	10,19	50601	10,19	70601
120408EN	0,8	14,34	51801			14,34	71801	14,34	31801	14,34	51801	14,34	71801
120412EN	1,2									14,34	52001		
P		•		•		•		•		•		•	
M						○							○
K			○		○				○		○		
N													
S													
H													
O													

## TCMT / TCGT

Designation	L mm	S mm	D1 mm	IC mm
TCMT 0902..	9,6	2,38	2,50	5,56
TC.T 1102..	11,0	2,38	2,80	6,35
TCMT 16T3..	16,5	3,97	4,40	9,52
TCMT 2204..	22,0	4,76	5,16	12,70

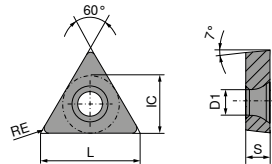

## TCMT / TCGT

ISO	RE mm	NEW						
		-SF CTCP125-P	-SMF CTCP115-P	-SMF CTCP135-P	-SM CTCP135-P	-SM CTCP115-P	-SM CTCP125-P	-SM CTCP135-P
		DRAGONSKIN	DRAGONSKIN	DRAGONSKIN	DRAGONSKIN	DRAGONSKIN	DRAGONSKIN	DRAGONSKIN
		F TCMT	F TCMT	F TCMT	M TCGT	M TCMT	M TCMT	M TCMT
		76 275 ...	76 284 ...	76 284 ...	76 270 ...	76 274 ...	76 274 ...	76 274 ...
		EUR 1A/08	EUR 1A/08	EUR 1A/08	EUR 1A/08	EUR 1A/08	EUR 1A/08	EUR 1A/08
090204EN	0,4						8,02 50401	8,02 70401
110202EN	0,2				14,22 71401			
110204EN	0,4	8,02 51601				8,02 31601	8,02 51601	8,02 71601
110208EN	0,8	8,02 51801	8,02 31801	8,02 71801		8,02 31801		8,02 71801
16T304EN	0,4	11,59 52801	11,59 32801			11,59 32801	11,59 52801	11,59 72801
16T308EN	0,8	11,59 53001	11,59 33001			11,59 33001	11,59 53001	11,59 73001
220408EN	0,8						16,68 54201	16,68 74201
P		●	●	●	●	●	●	●
M								
K		○	○	○	○	○	○	○
N								
S								
H								
O								

### VCMT / VCMT

Designation	L mm	S mm	D1 mm	IC mm
VC.T 1103..	11,1	3,18	2,9	6,35
VCMT 1604..	16,6	4,76	4,4	9,52

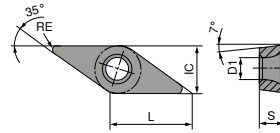

### VCMT / VCMT

		NEW	NEW	NEW	NEW	NEW	NEW
		-SF CTCP115-P	-SF CTCP115-P	-SF CTCP125-P	-SF CTCP125-P	-SF CTCP135-P	-SF CTCP135-P
		DRAGONSKIN	DRAGONSKIN	DRAGONSKIN	DRAGONSKIN	DRAGONSKIN	DRAGONSKIN
		F VCMT	F VCMT	F VCMT	F VCMT	F VCMT	F VCMT
		76 277 ...	76 279 ...	76 277 ...	76 279 ...	76 277 ...	76 279 ...
ISO	RE mm	EUR 1A/08	EUR 1A/08	EUR 1A/08	EUR 1A/08	EUR 1A/08	EUR 1A/08
110302EN	0,2	16,80 31401		16,80 51401		16,80 71401	
110304EN	0,4	16,80 31601		16,80 51601		16,80 71601	
110308EN	0,8	16,80 31801		16,80 51801		16,80 71801	
160404EN	0,4		16,80 32801		16,80 52801		16,80 72801
160408EN	0,8		16,80 33001		16,80 53001		
P		●	●	●	●	●	●
M						○	○
K		○	○	○	○		
N							
S							
H							
O							

### VCMT / VCMT

		NEW	NEW	NEW	NEW	NEW	NEW
		-SMF CTCP115-P	-SMF CTCP125-P	-SMF CTCP135-P	-SMF CTCP135-P	-SM CTCP115-P	-SM CTCP125-P
		DRAGONSKIN	DRAGONSKIN	DRAGONSKIN	DRAGONSKIN	DRAGONSKIN	DRAGONSKIN
		F VCMT	F VCMT	F VCMT	F VCMT	M VCMT	M VCMT
		76 288 ...	76 288 ...	76 285 ...	76 288 ...	76 278 ...	76 278 ...
ISO	RE mm	EUR 1A/08	EUR 1A/08	EUR 1A/08	EUR 1A/08	EUR 1A/08	EUR 1A/08
110302EN	0,2			16,80 71401			
110304EN	0,4	14,45 31601	14,45 51601		14,45 71601		
160404EN	0,4	16,80 32801	16,80 52801		16,80 72801	16,80 32801	16,80 52801
160406EN	0,6					16,80 32901	
160408EN	0,8	16,80 33001	16,80 53001		16,80 73001	16,80 33001	16,80 53001
160412EN	1,2					16,80 33201	16,80 53201
P		●	●	●	●	●	●
M				○	○		○
K		○	○			○	○
N							
S							
H							
O							

# Material examples for cutting data tables

	Material sub-group	Index	Composition / Structure / Heat treatment	Tensile strength N/mm <sup>2</sup> / HB / HRC	Material number	Material designation	Material number	Material designation
P	Unalloyed steel	P.1.1	< 0,15 % C Annealed	420 N/mm <sup>2</sup> / 125 HB	1.0401	C15	1.1141	Ck15
		P.1.2	< 0,45 % C Annealed	640 N/mm <sup>2</sup> / 190 HB	1.1191	C45E	1.0718	9SMnPb28
		P.1.3	< 0,45 % C Tempered	840 N/mm <sup>2</sup> / 250 HB	1.1191	C45E	1.0535	C55
		P.1.4	< 0,75 % C Annealed	910 N/mm <sup>2</sup> / 270 HB	1.1223	C60R	1.0535	C55
		P.1.5	< 0,75 % C Tempered	1010 N/mm <sup>2</sup> / 300 HB	1.1223	C60R	1.0727	45S20
	Low-alloy steel	P.2.1	Annealed	610 N/mm <sup>2</sup> / 180 HB	1.7131	16MnCr5	1.6587	17CrNiMo6
		P.2.2	Tempered	930 N/mm <sup>2</sup> / 275 HB	1.7131	16MnCr5	1.6587	17CrNiMo6
		P.2.3	Tempered	1010 N/mm <sup>2</sup> / 300 HB	1.7225	42CrMo4	1.3505	100Cr6
		P.2.4	Tempered	1200 N/mm <sup>2</sup> / 375 HB	1.7225	42CrMo4	1.3505	100Cr6
	High-alloy steel and high-alloy tool steel	P.3.1	Annealed	680 N/mm <sup>2</sup> / 200 HB	1.4021	X20Cr13	1.4034	X46Cr13
		P.3.2	Hardened and tempered	1100 N/mm <sup>2</sup> / 300 HB	1.2343	X38CrMoV5-1	1.4034	X46Cr13
		P.3.3	Hardened and tempered	1300 N/mm <sup>2</sup> / 400 HB	1.2343	X38CrMoV5-1	1.4034	X46Cr13
	Stainless steel	P.4.1	Ferritic / martensitic Annealed	680 N/mm <sup>2</sup> / 200 HB	1.4016	X6Cr17	1.2316	X36CrMo16
		P.4.2	Martensitic Tempered	1010 N/mm <sup>2</sup> / 300 HB	1.4112	X90CrMoV18	1.2316	X36CrMo16
M	Stainless steel	M.1.1	Austenitic / austenitic-ferritic Quenched	610 N/mm <sup>2</sup> / 180 HB	1.4301	X5CrNi18-10	1.4571	X6CrNiMoTi17-12-2
		M.2.1	Austenitic Tempered	300 HB	1.4841	X15CrNiSi25-21	1.4539	X1NiCrMoCu25-20-5
		M.3.1	Austenitic / ferritic (Duplex)	780 N/mm <sup>2</sup> / 230 HB	1.4462	X2CrNiMoN22-5-3	1.4501	X2CrNiMoCuWN25-7-4
K	Grey cast iron	K.1.1	Pearlitic / ferritic	350 N/mm <sup>2</sup> / 180 HB	0.6010	GG-10	0.6025	GG-25
		K.1.2	Pearlitic (martensitic)	500 N/mm <sup>2</sup> / 260 HB	0.6030	GG-30	0.6045	GG-45
	Spherulitic graphite cast iron	K.2.1	Ferritic	540 N/mm <sup>2</sup> / 160 HB	0.7040	GGG-40	0.7060	GGG-60
		K.2.2	Pearlitic	845 N/mm <sup>2</sup> / 250 HB	0.7070	GGG-70	0.7080	GGG-80
	Malleable iron	K.3.1	Ferritic	440 N/mm <sup>2</sup> / 130 HB	0.8035	GTW-35-04	0.8045	GTW-45
		K.3.2	Pearlitic	780 N/mm <sup>2</sup> / 230 HB	0.8165	GTS-65-02	0.8170	GTS-70-02
N	Aluminium wrought alloy	N.1.1	Non-hardenable	60 HB	3.0255	Al99,5	3.3315	AlMg1
		N.1.2	Hardenable Age-hardened	340 N/mm <sup>2</sup> / 100 HB	3.1355	AlCuMg2	3.2315	AlMgSi1
	Cast aluminium alloy	N.2.1	≤ 12 % Si, non-hardenable	250 N/mm <sup>2</sup> / 75 HB	3.2581	G-AlSi12	3.2163	G-AlSi9Cu3
		N.2.2	≤ 12 % Si, hardenable Age-hardened	300 N/mm <sup>2</sup> / 90 HB	3.2134	G-AlSi5Cu1Mg	3.2373	G-AlSi9Mg
		N.2.3	> 12 % Si, non-hardenable	440 N/mm <sup>2</sup> / 130 HB		G-AlSi17Cu4Mg		G-AlSi18CuNiMg
	Copper and copper alloys (bronze/brass)	N.3.1	Free-machining alloys, PB > 1 %	375 N/mm <sup>2</sup> / 110 HB	2.0380	CuZn39Pb2 (Ms58)	2.0410	CuZn44Pb2
		N.3.2	CuZn, CuSnZn	300 N/mm <sup>2</sup> / 90 HB	2.0331	CuZn15	2.4070	CuZn28Sn1As
		N.3.3	CuSn, lead-free copper and electrolytic copper	340 N/mm <sup>2</sup> / 100 HB	2.0060	E-Cu57	2.0590	CuZn40Fe
	Magnesium alloys	N.4.1	Magnesium and magnesium alloys	70 HB	3.5612	MgAl6Zn	3.5312	MgAl3Zn
	S	Heat-resistant alloys	S.1.1	Fe - basis Annealed	680 N/mm <sup>2</sup> / 200 HB	1.4864	X12NiCrSi 36-16	1.4865
S.1.2			Fe - basis Age-hardened	950 N/mm <sup>2</sup> / 280 HB	1.4980	X6NiCrTiMoVB25-15-2	1.4876	X10NiCrAlTi32-20
S.2.1			Ni or Co basis Annealed	840 N/mm <sup>2</sup> / 250 HB	2.4631	NiCr20TiAl (Nimonic80A)	3.4856	NiCr22Mo9Nb
S.2.2			Ni or Co basis Age-hardened	1180 N/mm <sup>2</sup> / 350 HB	2.4668	NiCr19Nb5Mo3 (Inconel 718)	2.4955	NiFe25Cr20NbTi
S.2.3			Ni or Co basis Cast	1080 N/mm <sup>2</sup> / 320 HB	2.4765	CoCr20W15Ni	1.3401	G-X120Mn12
Titanium alloys		S.3.1	Pure titanium	400 N/mm <sup>2</sup>	3.7025	Ti99,8	3.7034	Ti99,7
		S.3.2	Alpha + beta alloys Age-hardened	1050 N/mm <sup>2</sup> / 320 HB	3.7165	TiAl6V4	Ti-6246	Ti-6Al-2Sn-4Zr-6Mo
		S.3.3	Beta alloys	1400 N/mm <sup>2</sup> / 410 HB	Ti555.3	Ti-5Al-5V-5Mo-3Cr	R56410	Ti-10V-2Fe-3Al
H	Hardened steel	H.1.1	Hardened and tempered	46-55 HRC				
		H.1.2	Hardened and tempered	56-60 HRC				
		H.1.3	Hardened and tempered	61-65 HRC				
		H.1.4	Hardened and tempered	66-70 HRC				
	Chilled iron	H.2.1	Cast	400 HB				
	Hardened cast iron	H.3.1	Hardened and tempered	55 HRC				
O	Non-metal materials	O.1.1	Plastics, duroplastic	≤ 150 N/mm <sup>2</sup>				
		O.1.2	Plastics, thermoplastic	≤ 100 N/mm <sup>2</sup>				
		O.2.1	Aramid fibre-reinforced	≤ 1000 N/mm <sup>2</sup>				
		O.2.2	Glass/carbon-fibre reinforced	≤ 1000 N/mm <sup>2</sup>				
		O.3.1	Graphite					

\* Tensile strength

## Cutting data standard values

Index	DRAGONSKIN		
	CTCP115-P	CTCP125-P	CTCP135-P
P.1.1	370	295	210
P.1.2	315	250	175
P.1.3	270	210	145
P.1.4	250	200	135
P.1.5	230	180	120
P.2.1	325	260	180
P.2.2	250	195	130
P.2.3	230	180	120
P.2.4	170	130	85
P.3.1	200	170	150
P.3.2	140	105	95
P.3.3	85	40	35
P.4.1	200	170	155
P.4.2	170	135	125
M.1.1			155
M.2.1			95
M.3.1			135
K.1.1	255	170	
K.1.2	235	160	
K.2.1	270	180	
K.2.2	205	160	
K.3.1	250	200	
K.3.2	210	160	
N.1.1			
N.1.2			
N.2.1			
N.2.2			
N.2.3			
N.3.1			
N.3.2			
N.3.3			
N.4.1			
S.1.1			
S.1.2			
S.2.1			
S.2.2			
S.2.3			
S.3.1			
S.3.2			
S.3.3			
H.1.1			
H.1.2			
H.1.3			
H.1.4			
H.2.1			
H.3.1			
O.1.1			
O.1.2			
O.2.1			
O.2.2			
O.3.1			



The cutting data is strongly influenced by external conditions, such as the stability of the tool and workpiece clamping, material and type of machine. The specified values represent guideline cutting data that can be adjusted by approx. **±20%** according to the usage conditions.

## Table of contents

Overview of Clamping systems	40
Product programme	41-55

## CERATIZIT \ Performance





Premium quality tools for high performance.

The premium quality tools from the **CERATIZIT Performance** product line have been designed for specific applications and are distinguished by their outstanding performance. If you make high demands on the performance of your production and want to achieve the very best results, we recommend the Premium tools in this product line.

## Overview of Clamping systems

### Holders for positive inserts



Geometry	Tool holder	Page No.
	SCAC 90° DC	41
 CC..	SCDC 45° DC	42
	SCLC 95° DC	43
	SDAC 90° DC	44
 DC..	SDHC 107,5° DC	45
	SDJC 93° DC	46
	SDNC 62,5° DC	47
	SRDC 0° DC	48
 SC..	SSDC 45° DC	49
	SSSC 45° DC	50
 TC..	STGC 90° DC	51
 VC..	SVHC 107,5° DC	52
	SVJC 93° DC	53
	SVVC 72,5° DC	54
	SVZC 100° DC	55



# MaxiLock-S – SCAC 90° DC – Tool holder with screw clamping

▲ for sliding head lathes

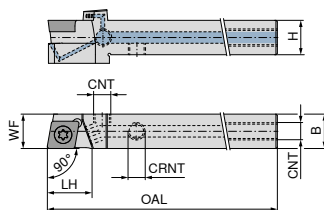

Illustrations show right-hand versions



**NEW** Left-hand **70 766 ...**  
**NEW** Right-hand **70 766 ...**

ISO designation	H mm	B mm	OAL mm	LH mm	WF mm	CNT	CRNT	torque moment Nm	Insert	EUR 2A/24	EUR 2A/24
SCAC R/L 1212 F09 DC	12	12	80	13	12	M6	M6	3,2	CC.. 09T3	139,50	01201
SCAC R/L 1212 M09 DC	12	12	150	13	12	M6	M6	3,2	CC.. 09T3	149,00	11201
SCAC R/L 1616 H09 DC	16	16	100	13	16	G1/8"	M6	3,2	CC.. 09T3	155,00	01601
SCAC R/L 2020 K12 DC	20	20	125	17	20	G1/8"	M6	5	CC.. 1204	164,30	02001

**Spare parts for Article no.**

Article no.	EUR 2A/28	EUR 2A/28	EUR 2A/28	EUR 2A/28	EUR 2A/28
70 766 01200 / 70 766 01201	3,30	859		3,13	86700
70 766 11200 / 70 766 11201	3,30	859		3,13	86700
70 766 01600 / 70 766 01601	3,92	87900	10,15 165	1,79 88000	3,13 86700
70 766 02000 / 70 766 02001	3,13	820	12,99 166	1,79 88000	3,13 86700

**Spare parts for Article no.**

Article no.	EUR 2A/28	EUR Y7	EUR 2A/28	EUR 2A/28	EUR 2A/28
70 766 01200 / 70 766 01201		9,42	120		
70 766 11200 / 70 766 11201		9,42	120		
70 766 01600 / 70 766 01601	1,26	87600	9,42 120	1,10 88100	24,54 87700
70 766 02000 / 70 766 02001	1,26	87600	9,42 120	1,10 88100	24,54 87700



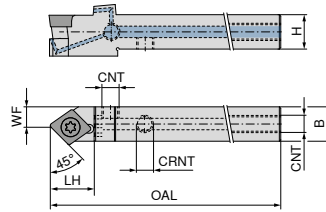

70 950 ...	70 950 ...	70 950 ...	70 950 ...	70 950 ...
EUR 2A/28	EUR 2A/28	EUR 2A/28	EUR 2A/28	EUR 2A/28
Sealing plugs DC	Key D	O-Ring	Coolant nozzle DC	Coolant screw plug
70 950 ...	80 950 ...	70 950 ...	70 950 ...	70 950 ...
EUR 2A/28	EUR Y7	EUR 2A/28	EUR 2A/28	EUR 2A/28

# MaxiLock-S – SCDC 45° DC – Tool holder with screw clamping



**NEW**  
Neutral  
**70 767 ...**

ISO designation	H mm	B mm	OAL mm	LH mm	WF mm	CNT	CRNT	torque moment Nm	Insert	EUR	
SCDC L 0808 K06 DC	8	8	125	13	4	M5	M5	1,2	CC.. 0602	139,50	00801
SCDC L 1010 M06 DC	10	10	150	13	5	M6	M6	1,2	CC.. 0602	139,50	01001
SCDC L 1212 M09 DC	12	12	150	18	6	M6	M6	3,2	CC.. 09T3	149,00	01201
SCDC L 1414 M09 DC	14	14	150	18	7	G1/8"	M6	3,2	CC.. 09T3	149,00	01401

	83 950 ...	80 950 ...	70 950 ...	70 950 ...	70 950 ...
					
Cylindrical screw					
					
Key D					
					
Coolant screw plug					
					
Clamping screw					
					
Grubscrew					
<b>Spare parts for Article no.</b>	<b>EUR</b>	<b>EUR</b>	<b>EUR</b>	<b>EUR</b>	<b>EUR</b>
70 767 00801	Y7	Y7	2A/28	2A/28	2A/28
70 767 01001	1,91	6,47		4,29	3,13
70 767 01201		039		857	86700
70 767 01401		120	3,74	859	86700
		120	294	859	86700

# MaxiLock-S – SCLC 95° DC – Tool holder with screw clamping

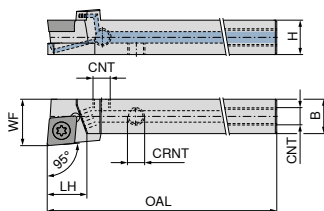

Illustrations show right-hand versions



**NEW** Left-hand **70 770 ...**  
**NEW** Right-hand **70 770 ...**

ISO designation	H mm	B mm	OAL mm	LH mm	WF mm	CNT	CRNT	torque moment Nm	Insert	Left-hand		Right-hand	
										EUR	01001	EUR	01000
SCLC R/L 1010 E06 DC	10	10	70	9	12	M6	M6	1,2	CC.. 0602	139,50	01001	139,50	01000
SCLC R/L 1212 F09 DC	12	12	80	15	16	M6	M6	3,2	CC.. 09T3	139,50	01201	139,50	01200
SCLC R/L 1616 H09 DC	16	16	100	17	20	G1/8"	M6	3,2	CC.. 09T3	155,00	01601	155,00	01600
SCLC R/L 2020 K09 DC	20	20	125	17	25	G1/8"	M6	3,2	CC.. 09T3	164,30	02001	164,30	02000
SCLC R/L 1616 H12 DC	16	16	100	20	20	G1/8"	M6	5	CC.. 1204	155,00	01601	155,00	11600
SCLC R/L 2020 K12 DC	20	20	125	20	25	G1/8"	M6	5	CC.. 1204	164,30	02001	164,30	12000
SCLC R/L 2525 M12 DC	25	25	150	20	32	G1/8"	M6	5	CC.. 1204	170,50	02501	170,50	02500
SCLC R/L 3225 P12 DC	32	25	170	20	32	G1/8"	G1/8"	5	CC.. 1204	179,00	03201	179,00	03200

**Spare parts for Article no.**

	70 950 ...		70 950 ...		70 950 ...		70 950 ...		70 950 ...	
	EUR		EUR		EUR		EUR		EUR	
70 770 01000 / 70 770 01001	4,29	857					3,13	86700		
70 770 01200 / 70 770 01201	3,30	859					3,13	86700		
70 770 01600 / 70 770 11601	3,92	87900	10,15	165	1,79	88000	3,13	86700	4,87	171
70 770 02000 / 70 770 12001	3,92	87900	10,15	165	1,79	88000	3,13	86700	4,87	171
70 770 11600 / 70 770 01601	3,13	820	12,99	166	1,79	88000	3,13	86700	4,87	170
70 770 12000 / 70 770 02001	3,13	820	12,99	166	1,79	88000	3,13	86700	4,87	170
70 770 02500 / 70 770 02501	3,13	820	12,99	166	1,79	88000	3,13	86700	4,87	170
70 770 03200 / 70 770 03201	3,13	820	12,99	166	1,79	88000			4,87	170

**Spare parts for Article no.**

	70 950 ...		80 950 ...		70 950 ...		70 950 ...		70 950 ...	
	EUR		EUR		EUR		EUR		EUR	
70 770 01000 / 70 770 01001			6,47	039						
70 770 01200 / 70 770 01201			9,42	120						
70 770 01600 / 70 770 11601	1,26	87600	9,42	120	1,10	88100	24,54	87700	3,74	294
70 770 02000 / 70 770 12001	1,26	87600	9,42	120	1,10	88100	24,54	87700	3,74	294
70 770 11600 / 70 770 01601	1,26	87600	9,42	120	1,10	88100	24,54	87700	3,74	294
70 770 12000 / 70 770 02001	1,26	87600	9,42	120	1,10	88100	24,54	87700	3,74	294
70 770 02500 / 70 770 02501	1,26	87600	9,42	120	1,10	88100	24,54	87700	3,74	294
70 770 03200 / 70 770 03201	1,26	87600	9,42	120	1,10	88100	24,54	87700	3,74	294

# MaxiLock-S – SDAC 90° DC – Tool holder with screw clamping

▲ for sliding head lathes

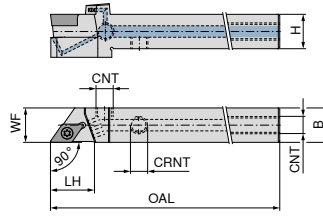
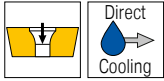

Illustrations show right-hand versions



	NEW		NEW
	Left-hand		Right-hand
	<b>70 771 ...</b>		<b>70 771 ...</b>
	EUR 2A/24		EUR 2A/24
	139,50 00801		139,50 00800
	139,50 01001		139,50 01000
	149,00 01201		149,00 01200
	149,00 11201		149,00 11200

ISO designation	H mm	B mm	OAL mm	LH mm	WF mm	CNT	CRNT	torque moment Nm	Insert
SDAC R/L 0808 K07 DC	8	8	125	14	8	M5	M5	1,2	DC.. 0702
SDAC R/L 1010 M07 DC	10	10	150	14	10	M6	M6	1,2	DC.. 0702
SDAC R/L 1212 M07 DC	12	12	150	14	12	M6	M6	1,2	DC.. 0702
SDAC R/L 1212 M11 DC	12	12	150	21	12	M6	M6	3,2	DC.. 11T3

**Spare parts for Article no.**

70 771 00800 / 70 771 00801		
70 771 01000 / 70 771 01001		
70 771 01200 / 70 771 01201		
70 771 11200 / 70 771 11201		

	NEW		NEW
	83 950 ...		80 950 ...
Cylindrical screw	EUR Y7		EUR Y7
Key D	1,91	157	6,47 039
Clamping screw			4,29 857
Grubscrew			3,13 86700
			6,47 039
			4,29 857
			9,42 120
			3,30 859

# MaxiLock-S – SDHC 107.5° DC – Tool holder with screw clamping

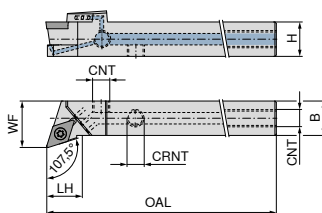

Illustrations show right-hand versions



**NEW** Left-hand **70 772 ...**  
**NEW** Right-hand **70 772 ...**

ISO designation	H mm	B mm	OAL mm	LH mm	WF mm	CNT	CRNT	torque moment Nm	Insert	EUR 2A/24	EUR 01201	EUR 2A/24	EUR 01200
SDHC R/L 1212 F07 DC	12	12	80	12,2	16	M6	M6	1,2	DC.. 0702	139,50	01201	139,50	01200
SDHC R/L 1616 H11 DC	16	16	100	11,6	20	G1/8"	M6	3,2	DC.. 11T3	155,00	01601	155,00	01600
SDHC R/L 2020 K11 DC	20	20	125	14,1	25	G1/8"	M6	3,2	DC.. 11T3	164,30	02001	164,30	02000
SDHC R/L 2525 M11 DC	25	25	150	20,5	32	G1/8"	M6	3,2	DC.. 11T3	170,50	02501	170,50	02500

**Spare parts for Article no.**

	EUR 2A/28	857	EUR 2A/28	106	EUR 2A/28	88000	EUR 2A/28	86700	EUR 2A/28	171
70 772 01200 / 70 772 01201	4,29	857					3,13	86700		
70 772 01600 / 70 772 01601	3,92	87900	7,86	106	1,79	88000	3,13	86700	4,87	171
70 772 02000 / 70 772 02001	3,92	87900	7,86	106	1,79	88000	3,13	86700	4,87	171
70 772 02500 / 70 772 02501	3,92	87900	7,86	106	1,79	88000	3,13	86700	4,87	171



**70 950 ...** **70 950 ...** **70 950 ...** **70 950 ...** **70 950 ...**

**Spare parts for Article no.**

	EUR 2A/28	87600	EUR Y7	039	EUR 2A/28	88100	EUR 2A/28	87700	EUR 2A/28	294
70 772 01200 / 70 772 01201			6,47	039						
70 772 01600 / 70 772 01601	1,26	87600	9,42	120	1,10	88100	24,54	87700	3,74	294
70 772 02000 / 70 772 02001	1,26	87600	9,42	120	1,10	88100	24,54	87700	3,74	294
70 772 02500 / 70 772 02501	1,26	87600	9,42	120	1,10	88100	24,54	87700	3,74	294



**70 950 ...** **80 950 ...** **70 950 ...** **70 950 ...** **70 950 ...**

# MaxiLock-S – SDJC 93° DC – Tool holder with screw clamping

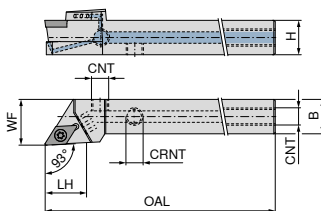

Illustrations show right-hand versions



NEW		NEW	
Left-hand		Right-hand	
70 773 ...		70 773 ...	
EUR		EUR	
2A/24		2A/24	
139,50	01001	139,50	01000
139,50	01201	139,50	01200
155,00	01601	155,00	01600
164,30	02001	164,30	02000
170,50	02501	170,50	02500

ISO designation	H mm	B mm	OAL mm	LH mm	WF mm	CNT	CRNT	torque moment Nm	Insert
SDJC R/L 1010 E07 DC	10	10	70	13,0	12	M6	M6	1,2	DC.. 0702
SDJC R/L 1212 F07 DC	12	12	80	14,3	16	M6	M6	1,2	DC.. 0702
SDJC R/L 1616 H11 DC	16	16	100	19,3	20	G1/8"	M6	3,2	DC.. 11T3
SDJC R/L 2020 K11 DC	20	20	125	19,9	25	G1/8"	M6	3,2	DC.. 11T3
SDJC R/L 2525 M11 DC	25	25	150	21,2	32	G1/8"	M6	3,2	DC.. 11T3

**Spare parts for Article no.**

70 773 01000 / 70 773 01001	4,29	857
70 773 01200 / 70 773 01201	4,29	857
70 773 01600 / 70 773 01601	3,92	87900
70 773 02000 / 70 773 02001	3,92	87900
70 773 02500 / 70 773 02501	3,92	87900

Clamping screw	Solid Carbide Seat D	Grubscrew	Grubscrew	Threaded sleeve	
70 950 ...	70 950 ...	70 950 ...	70 950 ...	70 950 ...	
EUR	EUR	EUR	EUR	EUR	
2A/28	2A/28	2A/28	2A/28	2A/28	
4,29	857		3,13	86700	
4,29	857		3,13	86700	
3,92	87900	7,86	106	1,79	88000
3,92	87900	7,86	106	1,79	88000
3,92	87900	7,86	106	1,79	88000
			3,13	86700	
			3,13	86700	
			3,13	86700	
			3,13	86700	
			4,87	171	
			4,87	171	
			4,87	171	

**Spare parts for Article no.**

70 773 01000 / 70 773 01001		
70 773 01200 / 70 773 01201		
70 773 01600 / 70 773 01601	1,26	87600
70 773 02000 / 70 773 02001	1,26	87600
70 773 02500 / 70 773 02501	1,26	87600

Sealing plugs DC	Key D	O-Ring	Coolant nozzle DC	Coolant screw plug
70 950 ...	80 950 ...	70 950 ...	70 950 ...	70 950 ...
EUR	EUR	EUR	EUR	EUR
2A/28	Y7	2A/28	2A/28	2A/28
	6,47			
	039			
	6,47			
	039			
	9,42	1,10	24,54	3,74
	120	88100	87700	294
	9,42	1,10	24,54	3,74
	120	88100	87700	294
	9,42	1,10	24,54	3,74
	120	88100	87700	294

# MaxiLock-S – SDNC 62.5° DC – Tool holder with screw clamping

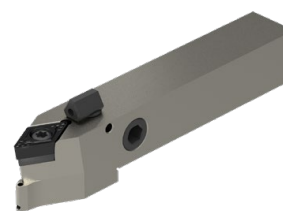
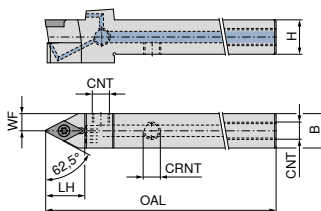

**NEW**  
Neutral  
**70 774 ...**

ISO designation	H mm	B mm	OAL mm	WF mm	CNT	CRNT	torque moment Nm	Insert	EUR 2A/24	
SDNC N 1212 F07 DC	12	12	80	6,0	M6	M6	1,2	DC.. 0702	139,50	01200
SDNC N 1212 M07 DC	12	12	150	6,0	M6	M6	1,2	DC.. 0702	149,00	11200
SDNC N 1212 M11 DC	12	12	150	6,0	M6	M6	3,2	DC.. 11T3	149,00	21200
SDNC N 1616 H11 DC	16	16	100	8,0	G1/8"	M6	3,2	DC.. 11T3	155,00	01600
SDNC N 2020 K11 DC	20	20	125	10,0	G1/8"	M6	3,2	DC.. 11T3	164,30	02000
SDNC N 2525 M11 DC	25	25	150	12,5	G1/8"	M6	3,2	DC.. 11T3	170,50	02500

**Spare parts for Article no.**

Article no.	Clamping screw	Solid Carbide Seat D	Grubscrew	Grubscrew	Threaded sleeve
70 774 01200	4,29 857			3,13 86700	
70 774 11200	4,29 857			3,13 86700	
70 774 01600	3,92 87900	7,86 106	1,79 88000	3,13 86700	4,87 171
70 774 02000	3,92 87900	7,86 106	1,79 88000	3,13 86700	4,87 171
70 774 21200	3,30 859			3,13 86700	
70 774 02500	3,92 87900	7,86 106	1,79 88000	3,13 86700	4,87 171

**Spare parts for Article no.**

Article no.	Sealing plugs DC	Key D	O-Ring	Coolant nozzle DC	Coolant screw plug
70 774 01200		6,47 039			
70 774 11200		6,47 039			
70 774 01600	1,26 87600	9,42 120	1,10 88100	24,54 87700	3,74 294
70 774 02000	1,26 87600	9,42 120	1,10 88100	24,54 87700	3,74 294
70 774 21200		9,42 120			
70 774 02500	1,26 87600	9,42 120	1,10 88100	24,54 87700	3,74 294

# MaxiLock-S – SRDC 0° DC – Tool holder with screw clamping

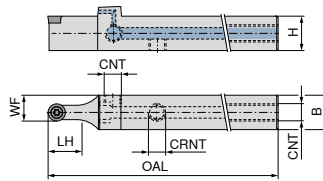

**NEW**  
Neutral  
**70 775 ...**

ISO designation	H mm	B mm	OAL mm	LH mm	WF mm	CNT	CRNT	torque moment Nm	Insert	EUR 2A/24	
SRDC N 1212 F06 DC	12	12	80	12,0	9,0	M6	M6	1,2	RC.. 0602 M0	172,90	01200
SRDC N 1616 H06 DC	16	16	100	12,0	11,0	G1/8"	M6	1,2	RC.. 0602 M0	174,90	01600
SRDC N 2020 K06 DC	20	20	125	12,0	13,0	G1/8"	M6	1,2	RC.. 0602 M0	164,30	02000
SRDC N 2525 M06 DC	25	25	150	12,4	15,5	G1/8"	M6	1,2	RC.. 0602 M0	170,50	02500
SRDC N 1616 H08 DC	16	16	100	16,0	12,0	G1/8"	M6	1,8	RC.. 0803 M0	174,90	11600
SRDC N 2020 K08 DC	20	20	125	16,5	14,0	G1/8"	M6	1,8	RC.. 0803 M0	164,30	12000
SRDC N 2525 M08 DC	25	25	150	16,5	16,5	G1/8"	M6	1,8	RC.. 0803 M0	170,50	12500
SRDC N 1616 H10 DC	16	16	100	20,9	13,0	G1/8"	M6	3,2	RC.. 1003 M0	174,90	21600
SRDC N 2020 K10 DC	20	20	125	20,0	15,0	G1/8"	M6	3,2	RC.. 1003 M0	164,30	22000
SRDC N 2525 M10 DC	25	25	150	20,9	17,5	G1/8"	M6	3,2	RC.. 1003 M0	170,50	22500

**Spare parts for Article no.**

	EUR 2A/28		EUR 2A/28		EUR 2A/28		EUR 2A/28		EUR 2A/28
70 775 01200	4,29	857					3,13	86700	
70 775 01600	4,29	857			1,79	88000	3,13	86700	
70 775 02000	4,29	857			1,79	88000	3,13	86700	
70 775 02500	4,29	857			1,79	88000	3,13	86700	
70 775 11600	3,30	819			1,79	88000	3,13	86700	
70 775 12000	3,30	819			1,79	88000	3,13	86700	
70 775 12500	3,30	819			1,79	88000	3,13	86700	
70 775 21600	3,92	87900	12,99	117	1,79	88000	3,13	86700	4,87 171
70 775 22000	3,92	87900	12,99	117	1,79	88000	3,13	86700	4,87 171
70 775 22500	3,92	87900	12,99	117	1,79	88000	3,13	86700	4,87 171

**Spare parts for Article no.**

	EUR 2A/28		EUR Y7		EUR 2A/28		EUR 2A/28		EUR 2A/28
70 775 01200			6,47	039					
70 775 01600	1,26	87600	6,47	039	1,10	88100	24,54	87700	3,74 294
70 775 02000	1,26	87600	6,47	039	1,10	88100	24,54	87700	3,74 294
70 775 02500	1,26	87600	6,47	039	1,10	88100	24,54	87700	3,74 294
70 775 11600	1,26	87600	8,89	118	1,10	88100	24,54	87700	3,74 294
70 775 12000	1,26	87600	8,89	118	1,10	88100	24,54	87700	3,74 294
70 775 12500	1,26	87600	8,89	118	1,10	88100	24,54	87700	3,74 294
70 775 21600	1,26	87600	9,42	120	1,10	88100	24,54	87700	3,74 294
70 775 22000	1,26	87600	9,42	120	1,10	88100	24,54	87700	3,74 294
70 775 22500	1,26	87600	9,42	120	1,10	88100	24,54	87700	3,74 294



# MaxiLock-S – SSDC 45° DC – Tool holder with screw clamping

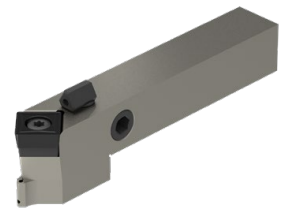
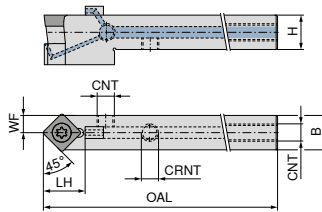

**NEW**  
Neutral  
**70 776 ...**

ISO designation	H mm	B mm	OAL mm	LH mm	WF mm	CNT	CRNT	torque moment Nm	Insert	EUR 2A/24	
SSDC N 1212 F09 DC	12	12	80	16	6,0	M6	M6	3,2	SC.. 09T3..	139,50	01200
SSDC N 1616 H09 DC	16	16	100	20	8,0	G1/8"	M6	3,2	SC.. 09T3..	155,00	01600
SSDC N 2020 K09 DC	20	20	125	20	10,0	G1/8"	M6	3,2	SC.. 09T3..	164,30	02000
SSDC N 1616 H12 DC	16	16	100	25	8,0	G1/8"	M6	5	SC.. 1204..	155,00	11600
SSDC N 2020 K12 DC	20	20	125	25	10,0	G1/8"	M6	5	SC.. 1204..	164,30	12000
SSDC N 2525 M12 DC	25	25	150	25	12,5	G1/8"	M6	5	SC.. 1204..	170,50	02500

**Spare parts for Article no.**

	70 950 ...	70 950 ...	70 950 ...	70 950 ...	70 950 ...
	EUR 2A/28	EUR 2A/28	EUR 2A/28	EUR 2A/28	EUR 2A/28
70 776 01200	3,92 87900			3,13 86700	
70 776 01600	3,92 87900	10,15 167	1,79 88000	3,13 86700	4,87 171
70 776 02000	3,92 87900	10,15 167	1,79 88000	3,13 86700	4,87 171
70 776 11600	3,13 820	12,99 168	1,79 88000	3,13 86700	4,87 170
70 776 12000	3,13 820	12,99 168	1,79 88000	3,13 86700	4,87 170
70 776 02500	3,13 820	12,99 168	1,79 88000	3,13 86700	4,87 170

**Spare parts for Article no.**

	70 950 ...	80 950 ...	70 950 ...	70 950 ...	70 950 ...
	EUR 2A/28	EUR Y7	EUR 2A/28	EUR 2A/28	EUR 2A/28
70 776 01200		9,42 120			
70 776 01600	1,26 87600	9,42 120	1,10 88100	24,54 87700	3,74 294
70 776 02000	1,26 87600	9,42 120	1,10 88100	24,54 87700	3,74 294
70 776 11600	1,26 87600	9,42 120	1,10 88100	24,54 87700	3,74 294
70 776 12000	1,26 87600	9,42 120	1,10 88100	24,54 87700	3,74 294
70 776 02500	1,26 87600	9,42 120	1,10 88100	24,54 87700	3,74 294

# MaxiLock-S – SSSC 45° DC – Tool holder with screw clamping

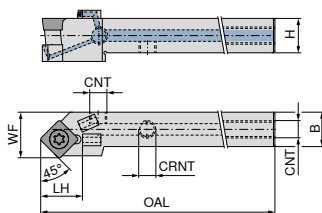

Illustrations show right-hand versions

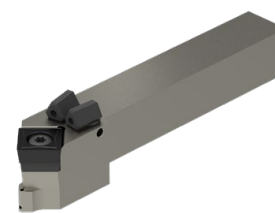

**NEW** Left-hand **NEW** Right-hand

ISO designation	H mm	B mm	OAL mm	LH mm	WF mm	CNT	CRNT	torque moment Nm	Insert	70 777 ...			
										EUR 2A/24	01201	EUR 2A/24	01200
SSSC R/L 1212 F09 DC	12	12	80	18	16	M6	M6	3,2	SC.. 09T3..	139,50	01201	139,50	01200
SSSC R/L 1616 H09 DC	16	16	100	20	20	G1/8"	M6	3,2	SC.. 09T3..	155,00	01601	155,00	01600
SSSC R/L 2020 K09 DC	20	20	125	20	25	G1/8"	M6	3,2	SC.. 09T3..	164,30	02001	164,30	02000
SSSC R/L 1616 H12 DC	16	16	100	25	20	G1/8"	M6	5	SC.. 1204..	155,00	11601	155,00	11600
SSSC R/L 2020 K12 DC	20	20	125	25	25	G1/8"	M6	5	SC.. 1204..	164,30	12001	164,30	12000
SSSC R/L 2525 M12 DC	25	25	150	25	32	G1/8"	M6	5	SC.. 1204..	170,50	02501	170,50	02500
SSSC L 3225 P 12 DC	32	25	170	25	32	G1/8"	G1/8"	5	SC.. 1204..	179,00	03201		

**Spare parts for Article no.**

	EUR 2A/28	859	EUR 2A/28	167	EUR 2A/28	88000	EUR 2A/28	86700	EUR 2A/28	171
70 777 01200 / 70 777 01201	3,30	859					3,13	86700		
70 777 01600 / 70 777 01601	3,92	87900	10,15	167	1,79	88000	3,13	86700	4,87	171
70 777 02000 / 70 777 02001	3,92	87900	10,15	167	1,79	88000	3,13	86700	4,87	171
70 777 11600 / 70 777 11601	3,13	820	12,99	168	1,79	88000	3,13	86700	4,87	170
70 777 12000 / 70 777 12001	3,13	820	12,99	168	1,79	88000	3,13	86700	4,87	170
70 777 02500 / 70 777 02501	3,13	820	12,99	168	1,79	88000	3,13	86700	4,87	170
70 777 03201	3,13	820	12,99	168	1,79	88000			4,87	170

**Spare parts for Article no.**

	EUR 2A/28	87600	EUR Y7	120	EUR 2A/28	88100	EUR 2A/28	87700	EUR 2A/28	294
70 777 01200 / 70 777 01201			9,42	120						
70 777 01600 / 70 777 01601	1,26	87600	9,42	120	1,10	88100	24,54	87700	3,74	294
70 777 02000 / 70 777 02001	1,26	87600	9,42	120	1,10	88100	24,54	87700	3,74	294
70 777 11600 / 70 777 11601	1,26	87600	9,42	120	1,10	88100	24,54	87700	3,74	294
70 777 12000 / 70 777 12001	1,26	87600	9,42	120	1,10	88100	24,54	87700	3,74	294
70 777 02500 / 70 777 02501	1,26	87600	9,42	120	1,10	88100	24,54	87700	3,74	294
70 777 03201	1,26	87600	9,42	120	1,10	88100	24,54	87700	3,74	294

70 950 ...	70 950 ...	70 950 ...	70 950 ...	70 950 ...
EUR 2A/28	EUR 2A/28	EUR 2A/28	EUR 2A/28	EUR 2A/28
3,30 859	10,15 167	1,79 88000	3,13 86700	4,87 171
3,92 87900	10,15 167	1,79 88000	3,13 86700	4,87 171
3,13 820	12,99 168	1,79 88000	3,13 86700	4,87 170
3,13 820	12,99 168	1,79 88000	3,13 86700	4,87 170
3,13 820	12,99 168	1,79 88000	3,13 86700	4,87 170
3,13 820	12,99 168	1,79 88000	3,13 86700	4,87 170

70 950 ...	80 950 ...	70 950 ...	70 950 ...	70 950 ...
EUR 2A/28	EUR Y7	EUR 2A/28	EUR 2A/28	EUR 2A/28
1,26 87600	9,42 120	1,10 88100	24,54 87700	3,74 294
1,26 87600	9,42 120	1,10 88100	24,54 87700	3,74 294
1,26 87600	9,42 120	1,10 88100	24,54 87700	3,74 294
1,26 87600	9,42 120	1,10 88100	24,54 87700	3,74 294
1,26 87600	9,42 120	1,10 88100	24,54 87700	3,74 294

# MaxiLock-S – STGC 90° DC – Tool holder with screw clamping

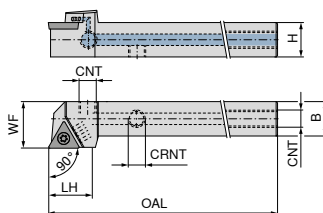

Illustrations show right-hand versions



**NEW** Left-hand **70 778 ...**  
**NEW** Right-hand **70 778 ...**

ISO designation	H mm	B mm	OAL mm	LH mm	WF mm	CNT	CRNT	torque moment Nm	Insert	EUR 2A/24	EUR 01201	EUR 2A/24	EUR 01200
STGC R/L 1212 F11 DC	12	12	80	15	16	M6	M6	1,2	TC.. 1102	139,50	01201	139,50	01200
STGC R/L 1616 H16 DC	16	16	100	22	20	G1/8"	M6	3,2	TC.. 16T3	155,00	01601	155,00	01600
STGC R/L 2020 K16 DC	20	20	125	22	25	G1/8"	M6	3,2	TC.. 16T3	164,30	02001	164,30	02000
STGC R/L 2525 M16 DC	25	25	150	22	32	G1/8"	M6	3,2	TC.. 16T3	170,50	02501	170,50	02500

**Spare parts for Article no.**

	EUR 2A/28	857	EUR 2A/28	169	EUR 2A/28	88000	EUR 2A/28	86700	EUR 2A/28	171
70 778 01200 / 70 778 01201	4,29	857	8,15	169	1,79	88000	3,13	86700	4,87	171
70 778 01600 / 70 778 01601	3,92	87900	8,15	169	1,79	88000	3,13	86700	4,87	171
70 778 02000 / 70 778 02001	3,92	87900	8,15	169	1,79	88000	3,13	86700	4,87	171
70 778 02500 / 70 778 02501	3,92	87900	8,15	169	1,79	88000	3,13	86700	4,87	171



**70 950 ...** **70 950 ...** **70 950 ...** **70 950 ...** **70 950 ...**

**Spare parts for Article no.**

	EUR 2A/28	87600	EUR Y7	039	EUR 2A/28	88100	EUR 2A/28	87700	EUR 2A/28	294
70 778 01200 / 70 778 01201	1,26	87600	6,47	039	1,10	88100	24,54	87700	3,74	294
70 778 01600 / 70 778 01601	1,26	87600	9,42	120	1,10	88100	24,54	87700	3,74	294
70 778 02000 / 70 778 02001	1,26	87600	9,42	120	1,10	88100	24,54	87700	3,74	294
70 778 02500 / 70 778 02501	1,26	87600	9,42	120	1,10	88100	24,54	87700	3,74	294



**70 950 ...** **80 950 ...** **70 950 ...** **70 950 ...** **70 950 ...**

# MaxiLock-S – SVHC 107.5° DC – Tool holder with screw clamping

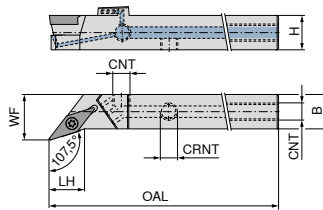

Illustrations show right-hand versions

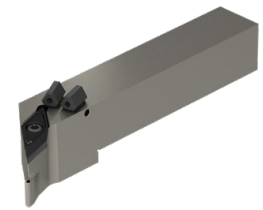

**NEW** Left-hand **70 779 ...**  
**NEW** Right-hand **70 779 ...**

ISO designation	H mm	B mm	OAL mm	LH mm	WF mm	CNT	CRNT	torque moment Nm	Insert	Left-hand		Right-hand	
										EUR	01201	EUR	01200
SVHC R/L 1212 F11 DC	12	12	80	11,9	16	M6	M6	1,2	VC.. 1103	174,00	01201	174,00	01200
SVHC R/L 1616 H11 DC	16	16	100	11,9	20	G1/8"	M6	1,2	VC.. 1103	179,00	01601	179,00	01600
SVHC R/L 2020 K11 DC	20	20	125	14,7	25	G1/8"	M6	1,2	VC.. 1103	184,00	02001	184,00	02000
SVHC R/L 2525 M11 DC	25	25	150	20,1	32	G1/8"	M6	1,2	VC.. 1103	189,00	02501	189,00	02500
SVHC R/L 2020 K16 DC	20	20	125	13,7	25	G1/8"	M6	3,2	VC.. 1604	184,00	12001	184,00	12000
SVHC R/L 2525 M16 DC	25	25	150	20,0	32	G1/8"	M6	3,2	VC.. 1604	189,00	12501	189,00	12500
SVHC R/L 3225 P16 DC	32	25	170	20,0	32	G1/8"	M6	3,2	VC.. 1604	194,00	03201	194,00	03200
SVHC R/L 2525 M22 DC	25	25	150	21,9	32	G1/8"	M6	5	VC.. 2205	189,00	22501	189,00	22500

**Spare parts for Article no.**

	70 950 ...		70 950 ...		70 950 ...		70 950 ...		70 950 ...	
	EUR		EUR		EUR		EUR		EUR	
70 779 01200 / 70 779 01201	4,29	857					3,13	86700		
70 779 01600 / 70 779 01601	4,29	857			1,79	88000	3,13	86700		
70 779 02000 / 70 779 02001	4,29	857			1,79	88000	3,13	86700		
70 779 02500 / 70 779 02501	4,29	857			1,79	88000	3,13	86700		
70 779 12000 / 70 779 12001	3,92	87900	10,56	107	1,79	88000	3,13	86700	4,87	171
70 779 12500 / 70 779 12501	3,92	87900	10,56	107	1,79	88000	3,13	86700	4,87	171
70 779 03200 / 70 779 03201	3,92	87900	10,56	107	1,79	88000	3,13	86700	4,87	171
70 779 22500 / 70 779 22501	3,13	820	14,02	109	1,79	88000	3,13	86700	4,87	170

**Spare parts for Article no.**

	70 950 ...		80 950 ...		70 950 ...		70 950 ...		70 950 ...	
	EUR		EUR		EUR		EUR		EUR	
70 779 01200 / 70 779 01201			6,47	039						
70 779 01600 / 70 779 01601	1,26	87600	6,47	039	1,10	88100	24,54	87700	3,74	294
70 779 02000 / 70 779 02001	1,26	87600	6,47	039	1,10	88100	24,54	87700	3,74	294
70 779 02500 / 70 779 02501	1,26	87600	6,47	039	1,10	88100	24,54	87700	3,74	294
70 779 12000 / 70 779 12001	1,26	87600	9,42	120	1,10	88100	24,54	87700	3,74	294
70 779 12500 / 70 779 12501	1,26	87600	9,42	120	1,10	88100	24,54	87700	3,74	294
70 779 03200 / 70 779 03201	1,26	87600	9,42	120	1,10	88100	24,54	87700	3,74	294
70 779 22500 / 70 779 22501	1,26	87600	9,42	120	1,10	88100	24,54	87700	3,74	294

# MaxiLock-S – SVJC 93° DC – Tool holder with screw clamping

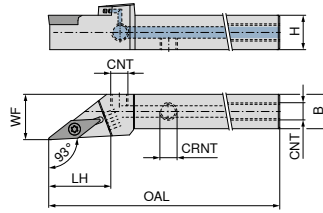
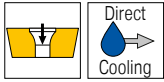

Illustrations show right-hand versions



ISO designation	H mm	B mm	OAL mm	LH mm	WF mm	CNT	CRNT	torque moment Nm	Insert
SVJC R/L 1212 F11 DC	12	12	80	21,6	16	M6	M6	1,2	VC.. 1103
SVJC R/L 1616 H11 DC	16	16	100	21,6	20	G1/8"	M6	1,2	VC.. 1103
SVJC R/L 2020 K11 DC	20	20	125	23,0	25	G1/8"	M6	1,2	VC.. 1103
SVJC R/L 2525 M11 DC	25	25	150	25,5	32	G1/8"	M6	1,2	VC.. 1103
SVJC R/L 2020 K16 DC	20	20	125	29,4	25	G1/8"	M6	3,2	VC.. 1604
SVJC R/L 2525 M16 DC	25	25	150	32,5	32	G1/8"	M6	3,2	VC.. 1604
SVJC R/L 3225 P16 DC	32	25	170	32,5	32	G1/8"	G1/8"	3,2	VC.. 1604

NEW Left-hand 70 780 ...		NEW Right-hand 70 780 ...	
EUR		EUR	
2A/24		2A/24	
170,50	01201	170,50	01200
174,00	01601	174,00	01600
179,00	02001	179,00	02000
189,00	02501	189,00	02500
179,00	12001	179,00	12000
189,00	12501	189,00	12500
194,00	03201	194,00	03200

Spare parts  
for Article no.

70 780 01200 / 70 780 01201	4,29	857
70 780 01600 / 70 780 01601	4,29	857
70 780 02000 / 70 780 02001	4,29	857
70 780 02500 / 70 780 02501	4,29	857
70 780 12000 / 70 780 12001	3,92	87900
70 780 12500 / 70 780 12501	3,92	87900
70 780 03200 / 70 780 03201	3,92	87900

Clamping screw	Solid Carbide Seat V	Grubscrew	Grubscrew	Threaded sleeve
70 950 ...	70 950 ...	70 950 ...	70 950 ...	70 950 ...
EUR	EUR	EUR	EUR	EUR
2A/28	2A/28	2A/28	2A/28	2A/28
4,29			3,13	86700
4,29		1,79	3,13	86700
4,29		1,79	3,13	86700
4,29		1,79	3,13	86700
3,92	10,56	1,79	3,13	86700
3,92	10,56	1,79	3,13	86700
3,92	10,56	1,79	4,87	171
			4,87	171
			4,87	171

Spare parts  
for Article no.

70 780 01200 / 70 780 01201		
70 780 01600 / 70 780 01601	1,26	87600
70 780 02000 / 70 780 02001	1,26	87600
70 780 02500 / 70 780 02501	1,26	87600
70 780 12000 / 70 780 12001	1,26	87600
70 780 12500 / 70 780 12501	1,26	87600
70 780 03200 / 70 780 03201	1,26	87600

Sealing plugs DC	Key D	O-Ring	Coolant nozzle DC	Coolant screw plug
70 950 ...	80 950 ...	70 950 ...	70 950 ...	70 950 ...
EUR	EUR	EUR	EUR	EUR
2A/28	Y7	2A/28	2A/28	2A/28
	6,47			
	6,47	1,10	24,54	3,74
	6,47	1,10	24,54	3,74
	6,47	1,10	24,54	3,74
	9,42	1,10	24,54	3,74
	9,42	1,10	24,54	3,74
	9,42	1,10	24,54	3,74

# MaxiLock-S – SVVC 72.5° DC – Tool holder with screw clamping

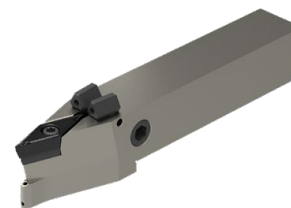
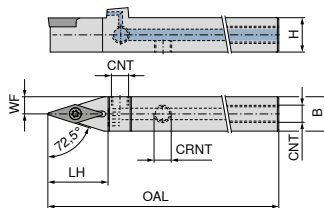

**NEW**

Neutral

**70 781 ...**

ISO designation	H mm	B mm	OAL mm	WF mm	CNT	CRNT	torque moment Nm	Insert	EUR 2A/24	
SVVC N 1212 F11 DC	12	12	80	6,0	M6	M6	1,2	VC.. 1103	170,50	01200
SVVC N 1616 H11 DC	16	16	100	8,0	G1/8"	M6	1,2	VC.. 1103	174,00	01600
SVVC N 2020 K11 DC	20	20	125	10,0	G1/8"	M6	1,2	VC.. 1103	179,00	02000
SVVC N 2525 M11 DC	25	25	150	12,5	G1/8"	M6	1,2	VC.. 1103	189,00	02500
SVVC N 2020 K16 DC	20	20	125	10,0	G1/8"	M6	3,2	VC.. 1604	179,00	12000
SVVC N 2525 M16 DC	25	25	150	12,5	G1/8"	M6	3,2	VC.. 1604	189,00	12500
SVVC N 3225 P16 DC	32	25	170	12,5	G1/8"	G1/8"	3,2	VC.. 1604	194,00	03200

**Spare parts for Article no.**

	EUR 2A/28		EUR 2A/28		EUR 2A/28		EUR 2A/28		EUR 2A/28
70 781 01200	4,29	857					3,13	86700	
70 781 01600	4,29	857			1,79	88000	3,13	86700	
70 781 02000	4,29	857			1,79	88000	3,13	86700	
70 781 02500	4,29	857			1,79	88000	3,13	86700	
70 781 12000	3,92	87900	10,56	107	1,79	88000	3,13	86700	4,87
70 781 12500	3,92	87900	10,56	107	1,79	88000	3,13	86700	4,87
70 781 03200	3,92	87900	10,56	107	1,79	88000			4,87

**Spare parts for Article no.**

	EUR 2A/28		EUR Y7		EUR 2A/28		EUR 2A/28		EUR 2A/28
70 781 01200			6,47	039					
70 781 01600	1,26	87600	6,47	039	1,10	88100	24,54	87700	3,74
70 781 02000	1,26	87600	6,47	039	1,10	88100	24,54	87800	3,74
70 781 02500	1,26	87600	6,47	039	1,10	88100	24,54	87700	3,74
70 781 12000	1,26	87600	9,42	120	1,10	88100	24,54	87800	3,74
70 781 12500	1,26	87600	9,42	120	1,10	88100	24,54	87800	3,74
70 781 03200	1,26	87600	9,42	120	1,10	88100	24,54	87700	3,74

# MaxiLock-S – SVZC 100° DC – Tool holder with screw clamping

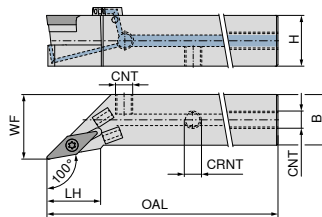

Illustrations show right-hand versions

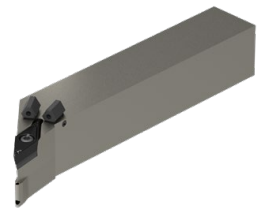

<b>NEW</b>	<b>NEW</b>
Left-hand	Right-hand
<b>70 783 ...</b>	<b>70 783 ...</b>
EUR 2A/24	EUR 2A/24
189,00 02501	189,00 02500

ISO designation	H mm	B mm	OAL mm	LH mm	WF mm	CNT	CRNT	torque moment Nm	Insert
SVZC R/L 2525 M16 DC	25	25	150	27,3	32	G1/8"	M6	3,2	VC.. 1604

**Spare parts for Article no.**  
70 783 02500 / 70 783 02501

Clamping screw	Solid Carbide Seat V	Grubscrew	Grubscrew	Threaded sleeve
<b>70 950 ...</b>	<b>70 950 ...</b>	<b>70 950 ...</b>	<b>70 950 ...</b>	<b>70 950 ...</b>
EUR 2A/28	EUR 2A/28	EUR 2A/28	EUR 2A/28	EUR 2A/28
3,92 87900	10,56 107	1,79 88000	3,13 86700	4,87 171

**Spare parts for Article no.**  
70 783 02500 / 70 783 02501

Sealing plugs DC	Key D	O-Ring	Coolant nozzle DC	Coolant screw plug
<b>70 950 ...</b>	<b>80 950 ...</b>	<b>70 950 ...</b>	<b>70 950 ...</b>	<b>70 950 ...</b>
EUR 2A/28	EUR Y7	EUR 2A/28	EUR 2A/28	EUR 2A/28
1,26 87600	9,42 120	1,10 88100	24,54 87700	3,74 294

## MaxiMill – Adjustable single angle milling cutter C 490-09

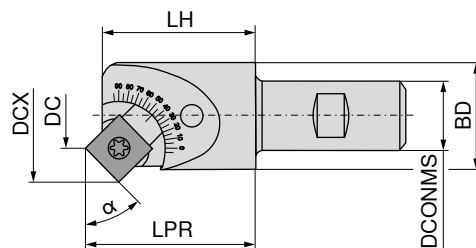

50 690 ...

ISO designation	DC mm	DCX mm	ZNF	DCONMS mm	LH mm	torque moment Nm	Insert
C490.20.R.01	1,6 - 11,1	20,1 - 23,6	1	16	32	3,2	SD.. 09T3..

EUR 2B  
151,00 01600

Spare parts	Cylindrical screw	Adjustment wedge	TORX® blade	Key D	Molykote	Clamping screw	Torque screwdriver
DCONMS	70 950 ...	70 950 ...	80 950 ...	80 950 ...	70 950 ...	70 950 ...	80 950 ...
16	EUR 2A 4,29 87500	EUR 2B 18,05 87200	EUR Y7 4,90 036	EUR Y7 9,56 113	EUR 2A/28 4,60 303	EUR 2A/28 3,30 110	EUR Y7 132,50 192

Other items for this system can be found in the main catalogue → chapter 15 from page 77

## MaxiMill – Adjustable single angle milling cutter C 490-12

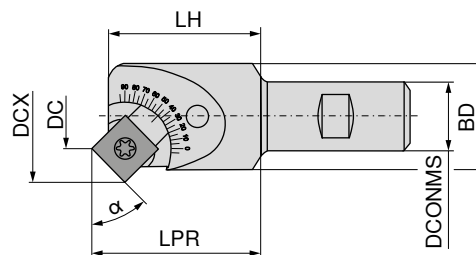

50 690 ...

ISO designation	DC mm	DCX mm	ZNF	DCONMS mm	LH mm	torque moment Nm	Insert
C490.26.R.01	1,1 - 14,1	26,6 - 31,5	1	20	37	5	SD.. 1205..

EUR 2B  
177,20 02000

Spare parts	Cylindrical screw	Adjustment wedge	TORX® blade	Key D	Molykote	Clamping screw	Torque screwdriver
DCONMS	70 950 ...	70 950 ...	80 950 ...	80 950 ...	70 950 ...	70 950 ...	80 950 ...
20	EUR 2A 3,38 87400	EUR 2B 18,05 87300	EUR Y7 4,90 037	EUR Y7 10,25 114	EUR 2A/28 4,60 303	EUR 2A/28 3,30 01200	EUR Y7 135,90 193

Other items for this system can be found in the main catalogue → chapter 15 from page 77



# Environmentally friendly, sustainable & cost-effective

## Certified recycling of valuable carbide

By deliberately conserving limited primary resources, we aim to significantly increase the proportion of recovered materials using carbide recycling. Our certified recycling process allows us to transform our used carbide products into a reusable powder and, using extremely low amounts of energy, to completely convert the finished product back into its original form.

## Join our sustainable material cycle

As part of our long-term partnership, we hope that we can together complete the cycle from the secondary raw material to a new finished product. Send us your used carbide. We will then process it in the approved manner. The price we offer for the returned carbide is always based on the current market price. Best of all: We take care of the entire process for you and also provide free, quantity-specific collection containers and transport solutions. Do you want to conserve valuable resources and make an important contribution to protecting the environment together with us? If so, our recycling process is just what you need.



# Shell mill adapter with reduced flange diameter

- ▲ Screwed drive dogs
- ▲ also available with Balluff chip **on request**

**Scope of supply:**

Base body with retaining screw and drive dog

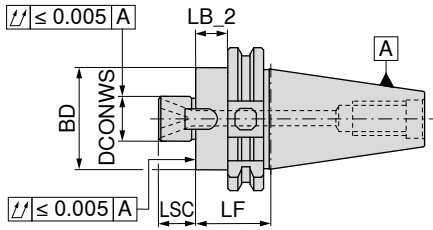

AD  
G 2,5 n<sub>max</sub> 18000

**82 315 ...**

EUR  
Y8  
92,73 12279  
90,42 12779

	Adapter	DCONWS mm	LB_2 mm	LF mm	BD mm	LSC mm	
short	SK 40	22	41	60	38	19	
	SK 40	27	25	44	48	21	
	SK 50	22	41	60	38	19	127,60 12278
	SK 50	27	25	44	48	21	129,80 12778

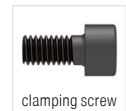
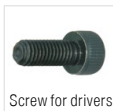

**83 950 ...**

EUR  
Y8

**83 950 ...**

EUR  
Y8

**83 950 ...**

EUR  
Y8

Spare parts	DCONWS							
22	M4x8	0,60	51700	10x7x20,5	8,45	51500	M10x25	3,43 124
27	M4x8	0,73	51800	12x9x24,3	9,63	51600	M12x30	3,78 125

# Shell mill adapter with reduced flange diameter

- ▲ Screwed drive dogs
- ▲ also available with Balluff chip **on request**

**Scope of supply:**

Base body with retaining screw and drive dog

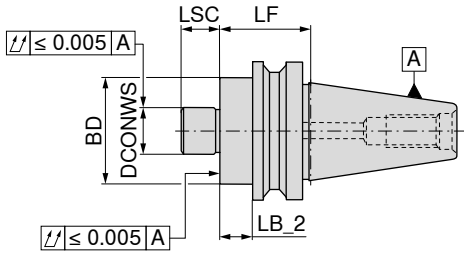

AD  
G 2,5 n<sub>max</sub> 18000

**82 315 ...**

EUR  
Y8  
88,71 12269  
85,79 12769

short	Adapter	DCONWS	LB_2	LF	BD	LSC		
		mm	mm	mm	mm	mm		
	BT 40	22	33	60	38	19		
	BT 40	27	25	52	48	21		
	BT 50	22	22	60	38	19	123,20	12268
	BT 50	27	25	63	48	21	127,10	12768

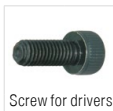

**83 950 ...**

EUR  
Y8

**83 950 ...**

EUR  
Y8

**83 950 ...**

EUR  
Y8

**Spare parts**

DCONWS								
22	M4x8	0,60	51700	10x7x20,5	8,45	51500	M10x25	3,43 124
27	M4x8	0,73	51800	12x9x24,3	9,63	51600	M12x30	3,78 125

# Shell mill adapter with reduced flange diameter

- ▲ Screwed drive dogs
- ▲ also available with Balluff chip **on request**

**Scope of supply:**

Base body with retaining screw and drive dog

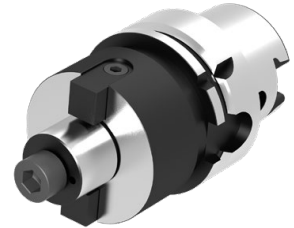
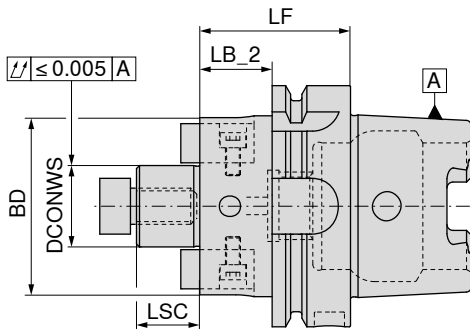

G 2,5 n<sub>max</sub> 25000

**82 315 ...**

EUR  
Y8

193,80 12257  
193,80 12757

196,40 12255  
196,40 12755

	Adapter	DCONWS mm	LB_2 mm	LF mm	BD mm	LSC mm
<b>short</b>	HSK-A 63	22	34	60	38	19
	HSK-A 63	27	34	60	48	21
	HSK-A 100	22	31	60	38	19
	HSK-A 100	27	31	60	48	21

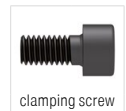
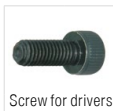

**83 950 ...**

EUR  
Y8

0,60 51700

**83 950 ...**

EUR  
Y8

8,45 51500

**83 950 ...**

EUR  
Y8

3,43 124

**Spare parts**

DCONWS								
22	M4x8	0,60	51700	10x7x20,5	8,45	51500	M10x25	3,43 124
27	M4x8	0,73	51800	12x9x24,3	9,63	51600	M12x30	3,78 125

# Hydraulic chuck with ABS connection

▲ for solid carbide and HSS shanks to h6 tolerance or better

### Scope of supply:

Base body including backstop screw

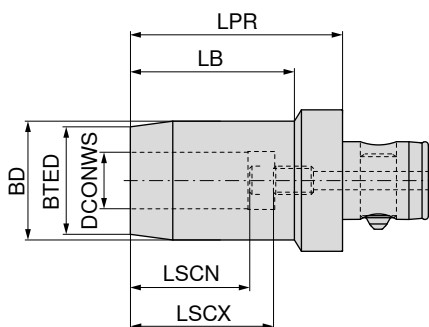

Adapter	DCONWS	BTED	BD	LPR	LB	LSCX	LSCN
	mm	mm	mm	mm	mm	mm	mm
ABS 40	6	22	26	55	36,5	37	27
ABS 40	8	24	28	60	42,0	37	27
ABS 40	10	26	30	65	47,5	41	31
ABS 40	12	28	32	65	48,0	46	36
ABS 50	6	22	26	55	33,5	37	27
ABS 50	8	24	28	55	34,0	37	27
ABS 50	10	26	30	65	45,0	41	31
ABS 50	12	28	32	65	45,5	46	36
ABS 50	14	30	34	65	46,0	46	36
ABS 50	16	34	38	70	52,0	49	39
ABS 50	18	36	40	70	52,5	49	39
ABS 50	20	38	42	75	58,0	51	41
ABS 63	20	38	42	78	56,0	51	41
ABS 63	25	53	57	85	60,0	57	47
ABS 63	32	60	64	90	61,0	61	51

### 84 253 ...

EUR	
Y8	
421,90	00688
421,90	00888
421,90	01088
421,90	01288
472,10	00697
472,10	00897
472,10	01097
472,10	01297
472,10	01497
472,10	01697
472,10	01897
472,10	02097
600,10	02096
600,10	02596
600,10	03296

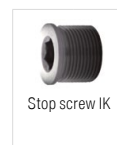

### Spare parts for Article no.

		EUR	
		Y7	
84 253 00688	M5x12,5 - SW2,5	8,35	418
84 253 00888	M6x12,5 - SW3	8,35	419
84 253 01088	M8x1x13,5 - SW3	8,35	420
84 253 01288	M10x1x13,5 - SW5	8,35	421
84 253 00697	M5x12,5 - SW2,5	8,35	418
84 253 00897	M6x12,5 - SW3	8,35	419
84 253 01097	M8x1x13,5 - SW3	8,35	420
84 253 01297	M10x1x13,5 - SW5	8,35	421
84 253 01497	M10x1x13,5 - SW5	8,35	421
84 253 01697	M10x1x13,5 - SW5	8,35	421
84 253 01897	M10x1x13,5 - SW5	8,35	421
84 253 02097	M16x1x13,5 - SW5	9,62	423
84 253 02096	M16x1x13,5 - SW5	9,62	423
84 253 02596	M16x1x13,5 - SW5	9,62	423
84 253 03296	M16x1x13,5 - SW5	9,62	423

### 83 950 ...

## SBF 3-jaw chuck (Ø 200 mm) with console

- ▲ Suitable for 5-axis machining of round components
- ▲ Compatible with PNG and MNG zero point clamping systems
- ▲ Quick change jaw system with single release of jaws
- ▲ Spindle with hex connection

### Scope of supply:

SBF 3-jaw chuck (Ø 200 mm) incl. console (PNG and MNG-compatible) without clamping bolt  
1 set GBA base jaws  
1 set SB-H stepped jaws  
6 fixing screws and clamping key

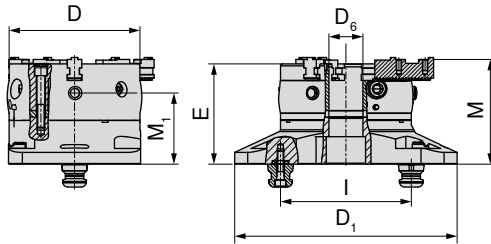

NEW

80 913 ...

EUR  
Y4  
3.390,00 20000

D	D <sub>1</sub>	D <sub>6</sub>	E	I	M	M <sub>1</sub>	MXC	TQX	DRVS	Stroke / jaw	Tooth pitch	WT
mm	mm	mm	mm	mm	mm	mm	kN	Nm	mm	mm	mm	kg
200	340	52	153,3	200	160,1	108,8	100	120	12	7	4,8	49,5

## SBF 3-jaw chuck (Ø 315 mm) with console

- ▲ Suitable for 5-axis machining of round components
- ▲ Compatible with PNG and MNG zero point clamping systems
- ▲ Quick change jaw system with single release of jaws
- ▲ Spindle with hex connection

### Scope of supply:

SBF 3-jaw chuck (Ø 315 mm) incl. console (PNG and MNG-compatible) without clamping bolt  
1 set GBA base jaws  
1 set SB-H stepped jaws  
6 fixing screws and clamping key

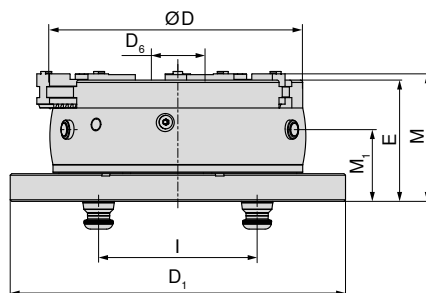

NEW

80 913 ...

EUR  
Y4  
5.590,00 31500

D	D <sub>1</sub>	D <sub>6</sub>	E	I	M	M <sub>1</sub>	MXC	TQX	DRVS	Stroke / jaw	Tooth pitch	WT
mm	mm	mm	mm	mm	mm	mm	kN	Nm	mm	mm	mm	kg
315	423	92	153	200	160,86	90,5	180	220	16	9,9	7	95



The chuck is designed exclusively for stationary use - do not use while rotating!

## System jaws overview

### Base jaws (GBA) – set

- ▲ Base jaws with angled teeth
- ▲ Price per set of 3 pieces

**Scope of supply:**

3 base jaws with angled teeth  
Including cylindrical screws

**SBF  
3**

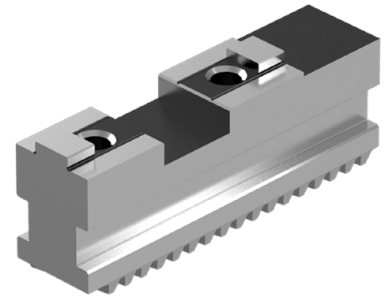
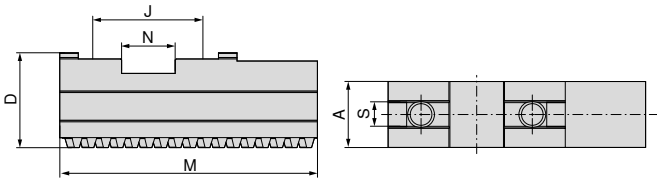

**NEW**

for	A	D	J	M	N	S	G	WT
	mm	mm	mm	mm	mm	mm		kg
SBF-3.200	22	32	40	90	20	10	M8x1	1,2
SBF-3.315	32	43	54	125	26	12	M12x1,5	3,1

**80 913 ...**

EUR	
Y4	
205,00	50300
337,00	60300

### Soft top jaws (AB-W) – set

- ▲ Price per set of 3 pieces
- ▲ Material: 16MnCr5

**Scope of supply:**

3 soft top jaws

**SBF  
3**

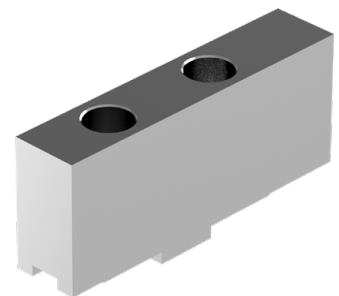
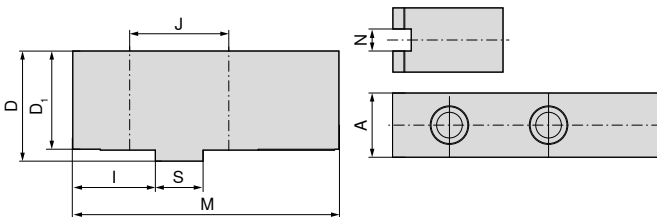

**NEW**

for	A	D	D <sub>1</sub>	I	J	M	N	S	Hole for	WT
	mm	mm	mm	mm	mm	mm	mm	mm		kg
SBF-3.200	22	47	43	35	40	105	10	20	M8	2,0
SBF-3.315	35	60	54	45	54	145	12	26	M12	5,6

**80 913 ...**

EUR	
Y4	
39,90	50400
82,50	60400

## System jaws overview

### Hard stepped top jaws (AB-H) – set

▲ Price per set of 3 pieces

**Scope of supply:**

3 hard stepped top jaws

**SBF**  
**3**

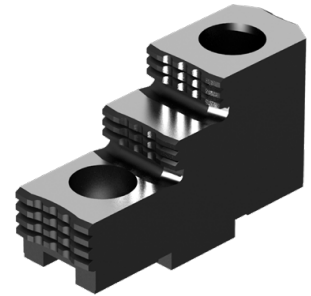
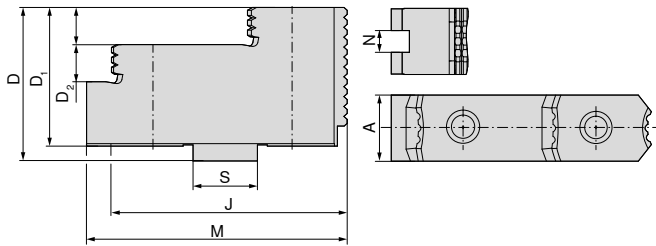

**NEW**

**80 913 ...**

EUR  
Y4

for	A mm	D mm	D <sub>1</sub> mm	D <sub>2</sub> mm	J mm	M mm	N mm	S mm	Hole for	WT kg
SBF-3.200	22	42	38	10	40	71,7	10	20	M8	2,4
SBF-3.315	36	62	56	15	54	105	12	26	M12	3,3

172,00 50200  
253,00 60200

### Hard stepped top jaws (SB-H) – set

▲ Stepped block jaws with angled teeth

▲ Price per set of 3 pieces

**Scope of supply:**

3 hard stepped block jaws

**SBF**  
**3**

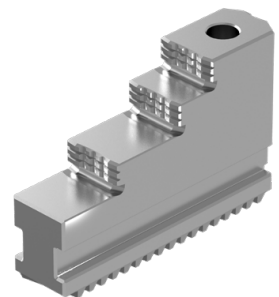
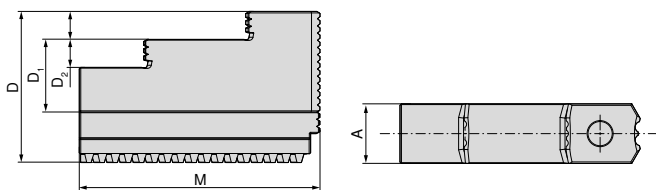

**NEW**

**80 913 ...**

EUR  
Y4

for	A mm	D mm	D <sub>1</sub> mm	D <sub>2</sub> mm	M mm	WT kg
SBF-3.200	22	60	35	10	94	1,9
SBF-3.315	32	81	46	15	129	5,5

351,00 50100  
554,00 60100





**The CERATIZIT-WNT Pro Cycling Team**

No other sport reflects the corporate values of CERATIZIT better than cycling. At the same time, it is directly related to the products that we develop, manufacture and sell every day, high-quality precision tools for the machining industry.



[www.ceratizit-wnt-pro-cycling.com](http://www.ceratizit-wnt-pro-cycling.com)

# HIGH QUALITY PERFORMANCE JUST LIKE OUR CUTTING TOOLS

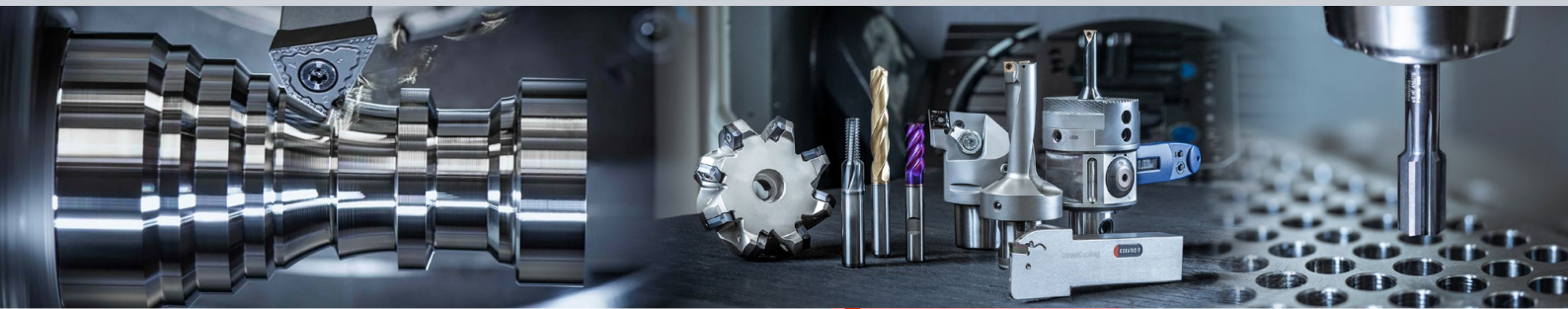

**TEAM CUTTING TOOLS**



CERATIZIT is a high-technology engineering group specialised in cutting tools and hard material solutions.

**Tooling the Future**

[www.ceratizit.com](http://www.ceratizit.com)

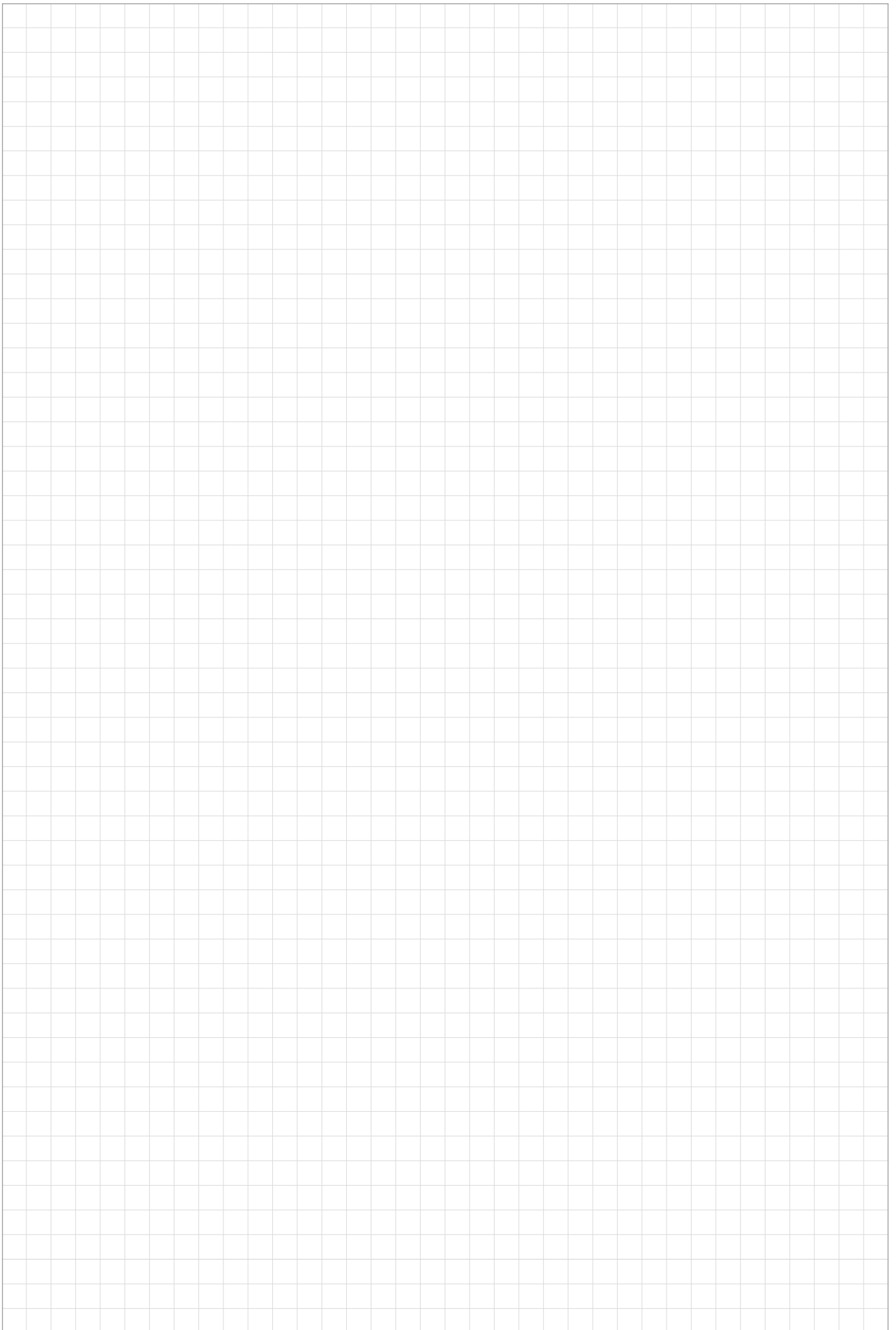



# UNITED. EXPERIENCED. METAL CUTTING.



**SPECIALIST FOR INDEXABLE INSERT TOOLS  
FOR TURNING, MILLING AND GROOVING**

The product brand CERATIZIT stands for high-quality indexable insert tools. The products are characterized by their high quality and contain the DNA of many years of experience in the development and production of carbide tools.



**THE QUALITY LABEL FOR  
EFFICIENT BORE PRODUCTION**

High-precision drilling, reaming, countersinking and boring is a matter of expertise: efficient tooling solutions for drilling and mechatronic tools are therefore part of the KOMET brand name.



**EXPERTS FOR ROTATING TOOLS,  
TOOL HOLDERS AND CLAMPING SOLUTIONS**

WNT is synonymous with product diversity: solid carbide and HSS rotating tools, tool holders and efficient workholding solutions are all part of this brand.



**CUTTING TOOLS  
FOR THE AEROSPACE INDUSTRY**

Solid carbide drills specially developed for the aerospace industry bear the product name KLENK. The highly specialised products are specifically designed for machining lightweight materials.